

ILLINOIS POLLUTION CONTROL BOARD
August 26, 1991

IN THE MATTER OF:)
)
PM-10 EMISSION LIMITS FOR THE)
McCOOK AND LAKE CALUMET AREAS)
OF COOK COUNTY, ILLINOIS, AND) R91-22
THE GRANITE CITY AREA OF) (Rulemaking)
MADISON COUNTY, ILLINOIS:)
AMENDMENTS TO 35 ILL.ADM.CODE)
PARTS 211 AND 212)

Proposed Rule. First Notice.

OPINION AND ORDER OF THE BOARD (by J. Theodore Meyer):

On August 19, 1991, the Illinois Environmental Protection Agency (Agency) filed this proposal for rulemaking. The proposal is intended to regulate particulate matter with an aerodynamic diameter less than or equal to a nominal 10 micrometers, which is known as PM-10. This proposal is directed at the McCook and Lake Calumet areas in Cook County, Illinois, and at the Granite City area in Madison County, Illinois. The Board accepted the proposal for hearing on August 22, 1991. The Board also accepted the Agency's certification that this rulemaking is federally required pursuant to Section 28.2 of the Environmental Protection Act (Act) (Ill.Rev.Stat. 1989, ch. 111 1/2, par. 1028.2), as amended by P.A. 86-1409.

Today the Board sends this proposal to first notice, as required by Section 5.01 of the Illinois Administrative Procedure Act. (Ill.Rev.Stat. 1989, ch. 127, par. 1005.01.) The proposal is submitted for publication as filed by the Agency. The Board has made only minor nonsubstantive changes to the rules as proposed by the Agency, in order to conform to Administrative Code Unit requirements. The Board emphasizes that in sending this proposal to first notice, it adopts no substantive position on the merits of the proposal. The Board believes that publishing the proposal at this time will maximize the opportunity for public comment on the proposal. Additionally, the Board has already stated that it places a very high priority on the quick resolution of this rulemaking. Beginning the statutorily-required first notice period at this time will allow for the most expeditious resolution of the proceeding.

The Board again notes that the Clean Air Act, as amended on November 15, 1990, requires Illinois to adopt and submit a state implementation plan (SIP) for PM-10 by November 15, 1991. (42 U.S.C. § 7513a.) According to the Agency's statement of reasons in support of this proposal, the PM-10 standards were adopted by

the United States Environmental Protection Agency (USEPA) on July 1, 1987, and Cook and Madison Counties were designated "Group I" areas by USEPA on August 7, 1987. Additionally, the Clean Air Act Amendments of 1990, which established the November 15, 1991 deadline for submittal of a PM-10 SIP, were signed into law on November 15, 1990. However, the Agency did not submit this proposal to the Board until August 19, 1991, less than three months before the November 15 deadline. Because of the notice, hearing, and comment requirements imposed on the Board's rulemaking process by several statutes, it is literally impossible for the Board to complete a rulemaking in three months. Nevertheless, the Board will proceed with this rulemaking as quickly as possible, while conforming with the requirements imposed by statute.

ORDER

The Board directs the Clerk of the Board to cause first notice publication of the following amendments in the Illinois Register.

TITLE 35: ENVIRONMENTAL PROTECTION
 SUBTITLE B: AIR POLLUTION
 CHAPTER I: POLLUTION CONTROL BOARD
 SUBCHAPTER c: EMISSION STANDARDS AND LIMITATIONS
 FOR STATIONARY SOURCES

PART 211
 DEFINITIONS AND GENERAL PROVISIONS

SUBPART A: GENERAL PROVISIONS

Section
 211.101 Incorporations by Reference
 211.102 Abbreviations and Units

SUBPART B: DEFINITIONS

Section
 211.121 Other Definitions
 211.122 Definitions

Appendix A Rule into Section Table
 Appendix B Section into Rule Table

AUTHORITY: Implementing Sections 9, 9.1 and 10 and authorized by Section 27 of the Environmental Protection Act (Ill. Rev. Stat. 1989, ch. 111½, pars. 1009, 1010 and 1027).

SOURCE: Adopted as Chapter 2: Air Pollution, Rule 201: Definitions, R71-23, 4 PCB 191, filed and effective April 14, 1972; amended in R74-2 and R75-5, 32 PCB 295, at 3 Ill. Reg. 5, p. 777, effective February 3, 1979; amended in R78-3 and 4, 35 PCB 75 and 243, at 3 Ill. Reg. 30, p. 124, effective July 28, 1979; amended in R80-5, at 7 Ill. Reg. 1244, effective January 21, 1983; codified

at 7 Ill. Reg. 13590; amended in R82-1 (Docket A) at 10 Ill. Reg. 12624, effective July 7, 1986; amended in R85-21(A) at 11 Ill. Reg. 11747, effective June 29, 1987; amended in R86-34 at 11 Ill. Reg. 12267, effective July 10, 1987; amended in R86-39 at 11 Ill. Reg. 20804, effective December 14, 1987; amended in R82-14 and R86-37 at 12 Ill. Reg. 787, effective December 24, 1987; amended in R86-18 at 12 Ill. Reg. 7284, effective April 8, 1988; amended in R86-10 at 12 Ill. Reg. 7621, effective April 11, 1988; amended in R88-23 at 13 Ill. Reg. 10862, effective June 27, 1989; amended in R89-8 at 13 Ill. Reg. 17457, effective January 1, 1990; amended in R89-16(A) at 14 Ill. Reg. 9141, effective May 23, 1990; amended in R88-30(B) at 15 Ill. Reg. 5223, effective March 28, 1991; amended in R88-14 at 15 Ill. Reg. 7901, effective May 14, 1991; amended in R91-22 at 15 Ill. Reg. _____, effective _____.

Section 211.101 Incorporations by Reference

The following materials are incorporated by reference. These incorporations do not include any later amendments or editions.

- a) "Evaporation Loss from Floating Roof Tanks," American Petroleum Institute Bulletin 2517, 1962
- b) Ringelmann Chart, Information Circular 833 (Revision of 1C7718), Bureau of Mines, U.S. Department of Interior, May 1, 1967
- c) Standard Industrial Classification Manual, Superintendent of Documents, Washington, D.C. 20402, 1972
- d) American Society for Testing and Materials, 1916 Race Street, Philadelphia, PA 19103

A.S.T.M. D-86
 A.S.T.M. D-240-64
 A.S.T.M. D-323
 A.S.T.M. D-369-69 (1971)
 A.S.T.M. D-396-69
 A.S.T.M. D-900-55
 A.S.T.M. D-975-68
 A.S.T.M. D-1826-64
 A.S.T.M. D-2015-66
 A.S.T.M. D-2880-71

- e) 40 CFR 51.100 (1987)

(Source: Amended at 15 Ill. Reg. _____, effective _____.)

Section 211.122 Definitions

"Accelacota": a pharmaceutical coating operation which consists of a horizontally rotating perforated drum in

which tablets are placed, a coating is applied by spraying and the coating is dried by the flow of air across the drum through the perforations.

"Accumulator": The reservoir of a condensing unit receiving the condensate from a surface condenser.

"Acid Gases": For the purposes of Section 9.4 of the Environmental Protection Act (the Act) (Ill. Rev. Stat. 1989, ch. 111 $\frac{1}{2}$, par. 1009.4), hydrogen chloride, hydrogen fluoride and hydrogen bromide, which exist as gases, liquid mist, or any combination thereof.

"Actual Heat Input": The quantity of heat produced by the combustion of fuel using the gross heating value of the fuel.

"Aeration": The practice of forcing air through bulk stored grain to maintain the condition of the grain.

"Afterburner": A device in which materials in gaseous effluents are combusted.

"Air Dried Coating": Coatings that dry by the use of air or forced air at temperatures up to 363.15° K (194° F).

"Air suspension coater/dryer": a pharmaceutical coating operation which consists of vertical chambers in which tablets or particles are placed, and a coating is applied and then dried while the tablets or particles are kept in a fluidized state by the passage of air upward through the chambers.

"Annual Grain Through-Put": Unless otherwise shown by the owner or operator, annual grain through-put for grain-handling operations, which have been in operation for three consecutive years prior to June 30, 1975, shall be determined by adding grain receipts and shipments for the three previous fiscal years and dividing the total by 6. The annual grain through-put for grain-handling operations in operation for less than three consecutive years prior to June 30, 1975, shall be determined by a reasonable three-year estimate; the owner or operator shall document the reasonableness of his three-year estimate.

"Architectural Coating": Any coating used for residential or commercial buildings or their appurtenances, or for industrial buildings which is site applied.

"Asphalt": The dark-brown to black cementitious material (solid, semisolid or liquid in consistency) of which the main constituents are bitumens which occur naturally or as a residue of petroleum refining.

"Asphalt Prime Coat": A low-viscosity liquid asphalt applied to an absorbent surface as the first of more than one asphalt coat.

"Automobile": Any first division motor vehicle as that term is defined in the Illinois Vehicle Code (Ill. Rev. Stat. 1989, ch. 95½, pars 1-100 et seq.).

"Automobile or Light-Duty Truck Manufacturing Plant": A facility where parts are manufactured or finished for eventual inclusion into a finished automobile or light-duty truck ready for sale to vehicle dealers, but not including customizers, body shops and other repainters.

"Batch Loading": The process of loading a number of individual parts at the same time for degreasing.

"Bead-Dipping": The dipping of an assembled tire bead into a solvent-based cement.

"British Thermal Unit": The quantity of heat required to raise one pound of water from 60° F to 61° F (abbreviated btu).

"Bulk Gasoline Plant": Any gasoline storage and distribution facility that receives gasoline from bulk gasoline terminals by delivery vessels and distributes gasoline to gasoline dispensing facilities.

"Bulk Gasoline Terminal": Any gasoline storage and distribution facility that receives gasoline by pipeline, ship or barge, and distributes gasoline to bulk gasoline plants or gasoline dispensing facilities.

"Can Coating": The application of a coating material to a single walled container that is manufactured from metal sheets thinner than 29 gauge (0.0141 in).

"Certified Investigation": A report signed by Illinois Environmental Protection Agency (Agency) personnel certifying whether a grain-handling operation (or portion thereof) or grain-drying operation is causing or tending to cause air pollution. Such report must describe the signatory's investigation, including a summary of those facts on which he relies to certify whether the grain-handling or grain-drying operation is causing or threatening or allowing the discharge or emission of any

contaminant into the environment so as to cause or tend to cause air pollution in Illinois, either alone or in combination with contaminants from other sources, or so as to violate regulations or standards adopted by the Pollution Control Board (Board) under the Environmental Protection Act (Act). The certified investigation shall be open to a reasonable public inspection and may be copied upon payment of the actual cost of reproducing the original.

"Choke Loading": That method of transferring grain from the grain-handling operation to any vehicle for shipment or delivery which precludes a free fall velocity of grain from a discharge spout into the receiving container.

"Cleaning and Separating Operation": That operation where foreign and undesired substances are removed from the grain.

"Clear Coating": Coatings that lack color and opacity or are transparent using the undercoat as a reflectant base or undertone color.

"Closed Purge System": A system that is not open to the atmosphere and that is composed of piping, connections, and, if necessary, flow inducing devices that transport liquid or vapor from a piece or pieces of equipment to a control device, or return the liquid or vapor to the process line.

"Closed Vent System": A system that is not open to the atmosphere and that is composed of piping, connections, and, if necessary, flow inducing devices that transport gas or vapor from a piece or pieces of equipment to a control device, or return the gas or vapor to the process line.

"Coal Refuse": Waste products of coal mining, cleaning and coal preparation operations containing coal, matrix material, clay and other organic and inorganic material.

"Coating Applicator": Equipment used to apply a surface coating.

"Coating Line": An operation where a surface coating is applied to a material and subsequently the coating is dried and/or cured.

"Coating Plant": Any building, structure or installation that contains a coating line and which is located on one or more contiguous or adjacent properties and which is

owned or operated by the same person (or by persons under common control).

"Coil Coating": The application of a coating material to any flat metal sheet or strip that comes in rolls or coils.

"Cold Cleaning": The process of cleaning and removing soils from surfaces by spraying, brushing, flushing or immersion while maintaining the organic solvent below its boiling point. Wipe cleaning is not included in this definition.

"Complete Combustion": A process in which all carbon contained in a fuel or gas stream is converted to carbon dioxide.

"Component": Any piece of equipment which has the potential to leak volatile organic material including, but not limited to, pump seals, compressor seals, seal oil degassing vents, pipeline valves, pressure relief devices, process drains and open ended valves. This definition excludes valves which are not externally regulated, flanges, and equipment in heavy liquid service. For purposes of 35 Ill. Adm. Code 215. Subpart Q, this definition also excludes bleed ports of gear pumps in polymer service.

"Concentrated Nitric Acid Manufacturing Process": Any acid producing facility manufacturing nitric acid with a concentration equal to or greater than 70 percent by weight.

"Condensate": Hydrocarbon liquid separated from its associated gasses which condenses due to changes in the temperature or pressure and remains liquid at standard conditions.

"Control Device": Equipment, such as an afterburner, adsorber, scrubber, condenser, cyclone or baghouse used to remove or prevent the emission of air pollutants from a contaminated exhaust stream. For purposes of 35 Ill. Adm. Code 215, Subpart Q, an enclosed combustion device, vapor recovery system, flare, or closed container.

"Conveyorized Degreasing": The continuous process of cleaning and removing soils from surfaces utilizing either cold or vaporized solvents.

"Crude Oil": A naturally occurring mixture which consists of hydrocarbons and sulfur, nitrogen or oxygen

derivatives of hydrocarbons and which is a liquid at standard conditions.

"Crude Oil Gathering": The transportation of crude oil or condensate after custody transfer between a production facility and a reception point.

"Crushing": The fragmentation of non-metallic minerals by a machine such as a jaw, gyratory, cone, roll, rod, mill, hammermill, and impactor.

"Custody Transfer": The transfer of produced petroleum and/or condensate after processing and/or treating in the producing operations, from storage tanks or automatic transfer facilities to pipelines or any other forms of transportation.

"Cutback Asphalt": Any asphalt which has been liquified by blending with petroleum solvents other than residual fuel oil and has not been emulsified with water.

"Degreaser": Any equipment or system used in solvent cleaning.

"Delivery Vessel": Any tank truck or trailer equipped with a storage tank that is used for the transport of gasoline to a stationary storage tank at a gasoline dispensing facility, bulk gasoline plant or bulk gasoline terminal.

"Distillate Fuel Oil": Fuel oils of grade No. 1 or 2 as specified in detailed requirements for fuel oil A.S.T.M. D-369-69 (1971).

"Dry Cleaning Facility": A facility engaged in the cleaning of fabrics using an essentially nonaqueous solvent by means of one or more solvent washes, extraction of excess solvent by spinning and drying by tumbling in an airstream. The facility includes, but is not limited to, washers, dryers, filter and purification systems, waste disposal systems, holding tanks, pumps and attendant piping and valves.

"Dump-Pit Area": Any area where grain is received at a grain-handling or grain-drying operation.

"Effective Grate Area": That area of a dump-pit grate through which air passes, or would pass, when aspirated.

"Effluent Water Separator": Any tank, box, sump or other apparatus in which any organic material floating on or entrained or contained in water entering such tank, box,

sump or other apparatus is physically separated and removed from such water prior to outfall, drainage or recovery of such water.

"Emission Rate": Total quantity of any air contaminant discharge into the atmosphere in any one-hour period.

"Enclose": with respect to Subpart T, to cover any volatile organic liquid surface that is exposed to the atmosphere.

"End Sealing Compound Coat": A compound applied to can ends which functions as a gasket when the end is assembled on the can.

"Excess Air": Air supplied in addition to the theoretical quantity necessary for complete combustion of all fuel and/or combustible waste material.

"Excessive Release": A discharge of more than 295g (0.65 pounds) of mercaptans and/or hydrogen sulfide into the atmosphere in any five minute period.

"Existing Grain-Drying Operation": Any grain-drying operation the construction or modification of which was commenced prior to June 30, 1975.

"Existing Grain-Handling Operation": Any grain-handling operation the construction or modification of which was commenced prior to June 30, 1975.

"Exterior Base Coat": An initial coating applied to the exterior of a can after the can body has been formed.

"Exterior End Coat": A coating applied by rollers or spraying to the exterior end of a can.

"External Floating Roof": A storage vessel cover in an open top tank consisting of a double deck or pontoon single deck which is supported by the petroleum liquid being contained and is equipped with a closure seal between the deck edge and tank wall.

"Extreme Performance Coating": Coatings designed for exposure to any of the following: the ambient weather conditions, temperatures above 368.15° K (203° F), detergents, abrasive and scouring agents, solvents, corrosive atmospheres, or other similar extreme environmental conditions.

"Fabric Coating": The coating of a textile substrate.

"Final Repair Coat": The repainting of any coating which is damaged during vehicle assembly.

"Firebox": The chamber or compartment of a boiler or furnace in which materials are burned, but not the combustion chamber or afterburner of an incinerator.

"Flexographic Printing": The application of words, designs and pictures to a substrate by means of a roll printing technique in which the pattern to be applied is raised above the printing roll and the image carrier is made of elastomeric materials.

"Floating Roof": A roof on a stationary tank, reservoir or other container which moves vertically upon change in volume of the stored material.

"Freeboard Height": For open top vapor degreasers, the distance from the top of the vapor zone to the top of the degreaser tank. For cold cleaning degreasers, the distance from the solvent to the top of the degreaser tank.

"Fuel Combustion Emission Source": Any furnace, boiler or similar equipment used for the primary purpose of producing heat or power by indirect heat transfer.

"Fuel Gas System": A system for collection of refinery fuel gas including, but not limited to, piping for collecting tail gas from various process units, mixing drums and controls and distribution piping.

"Fugitive Particulate Matter": Any particulate matter emitted into the atmosphere other than through a stack, provided that nothing in this definition or in 35 Ill. Adm. Code 212.Subpart K shall exempt any source from compliance with other provisions of 35 Ill. Adm. Code 212 otherwise applicable merely because of the absence of a stack.

"Gas Service": Means that the component contains process fluid that is in the gaseous state at operating conditions.

"Gasoline": Any petroleum distillate having a Reid vapor pressure of 4 pounds or greater.

"Gasoline Dispensing Facility": Any site where gasoline is transferred from a stationary storage tank to a motor vehicle gasoline tank used to provide fuel to the engine of that motor vehicle.

"Grain": The whole kernel or seed of corn, wheat, oats, soybeans and any other cereal or oil seed plant; and the normal fines, dust and foreign matter which results from harvesting, handling or conditioning. The grain shall be unaltered by grinding or processing.

"Grain-Drying Operation": Any operation, excluding aeration, by which moisture is removed from grain and which typically uses forced ventilation with the addition of heat.

"Grain-Handling and Conditioning Operation": A grain storage facility and its associate grain transfer, cleaning, drying, grinding and mixing operations.

"Grain-Handling Operation": Any operation where one or more of the following grain-related processes (other than grain-drying operation, portable grain-handling equipment, one-turn storage space, and excluding flour mills and feed mills) are performed: receiving, shipping, transferring, storing, mixing or treating of grain or other processes pursuant to normal grain operations.

"Green Tire Spraying": The spraying of green tires, both inside and outside, with release compounds which help remove air from the tire during molding and prevent the tire from sticking to the mold after curing.

"Green Tires": Assembled tires before molding and curing have occurred.

"Gross Heating Value": Amount of heat produced when a unit quantity of fuel is burned to carbon dioxide and water vapor, and the water vapor condensed as described in A.S.T.M. D-2015-66, D-900-55, D-1826-64 and D-240-64.

"Heavy Liquid": Liquid with a true vapor pressure of less than 0.3 kPa (0.04 psi) at 294.3° K (70° F) or 0.1 Reid Vapor Pressure as determined by A.S.T.M. method D-323; or which when distilled requires a temperature of 300° F or greater to recover 10% of the liquid as determined by A.S.T.M. method D-86.

"Heavy Metals": For the purposes of Section 9.4 of the Act, elemental, ionic, or combined forms of arsenic, cadmium, mercury, chromium, nickel and lead.

"Heavy, Off-Highway Vehicle Products": For the purposes of Section 215.204(k), heavy off-highway vehicle products shall include: heavy construction, mining, farming or

material handling equipment; heavy industrial engines; diesel-electric locomotives and associated power generation equipment; and the components of such equipment or engines.

"Hot Well": The reservoir of a condensing unit receiving the condensate from a barometric condenser.

"Housekeeping Practices": Those activities specifically defined in the list of housekeeping practices developed by the Joint EPA - Industry Task Force and included herein under 35 Ill. Adm. Code 212.461.

"Incinerator": Combustion apparatus in which refuse is burned.

"Indirect Heat Transfer": Transfer of heat in such a way that the source of heat does not come into direct contact with process materials.

"In-Process Tank": A container used for mixing, blending, heating, reacting, holding, crystallizing, evaporating, or cleaning operations in the manufacture of pharmaceuticals.

"In-situ Sampling Systems": Nonextractive samplers or in-line samplers.

"Interior Body Spray Coat": A coating applied by spray to the interior of a can after the can body has been formed.

"Internal Transferring Area": Areas and associated equipment used for conveying grain among the various grain operations.

"Large Appliance Coating": The application of a coating material to the component metal parts (including but not limited to doors, cases, lids, panels and interior support parts) of residential and commercial washers, dryers, ranges, refrigerators, freezers, water heaters, dishwashers, trash compactors, air conditioners and other similar products.

"Light-Duty Truck": Any second division motor vehicle, as that term is defined in the Illinois Vehicle Code, (Ill. Rev. Stat. 1989, ch. 95½, pars. 1-100 et seq.) weighing less than 3854 kilograms (8500 pounds) gross.

"Liquid-Mounted Seal": A primary seal mounted in continuous contact with the liquid between the tank wall

and the floating roof edge around the circumference of the roof.

"Liquid Service": Means that the equipment or component contains process fluid that is in a liquid state at operating conditions.

"Liquids Dripping": Any visible leaking from a seal including spraying, misting, clouding and ice formation.

"Load-Out Area": Any area where grain is transferred from the grain-handling operation to any vehicle for shipment or delivery.

"Low Solvent Coating": A coating which contains less organic solvent than the conventional coatings used by the industry. Low solvent coatings include water-borne, higher solids, electro-deposition and powder coatings.

"Magnet Wire Coating": The application of a coating of electrically insulating varnish or enamel to conducting wire to be used in electrical machinery.

"Major Dump Pit": Any dump pit with an annual grain through-put of more than 300,000 bushels, or which receives more than 40% of the annual grain through-put of the grain-handling operation.

"Major Metropolitan Area (MMA)": Any county or group of counties which is defined by the following Table:

MAJOR METROPOLITAN AREAS IN ILLINOIS (MMA's)

MMA	COUNTIES INCLUDED IN MMA
Champaign-Urbana	Champaign
Chicago	Cook, Lake, Will, DuPage, McHenry, Kane, Grundy, Kendall, Kankakee
Decatur	Macon
Peoria	Peoria, Tazewell
Rockford	Winnebago
Rock Island -- Moline	Rock Island
Springfield	Sangamon
St. Louis (Illinois)	St. Clair, Madison
Bloomington -- Normal	McLean

"Major Population Area (MPA)": Areas of major population concentration in Illinois, as described below:

The area within the counties of Cook; Lake; DuPage; Will; the townships of Burton, Richmond, McHenry,

Greenwood, Nunda, Door, Algonquin, Grafton and the municipality of Woodstock, plus a zone extending two miles beyond the boundary of said municipality located in McHenry County; the townships of Dundee, Rutland, Elgin, Plato, St. Charles, Campton, Geneva, Blackberry, Batavia, Sugar Creek and Aurora located in Kane County; and the municipalities of Kankakee, Bradley and Bourbonnais, plus a zone extending two miles beyond the boundaries of said municipalities in Kankakee County.

The area within the municipalities of Rockford and Loves Park, plus a zone extending two miles beyond the boundaries of said municipalities.

The area within the municipalities of Rock Island, Moline, East Moline, Carbon Cliff, Milan, Oak Grove, Silvis, Hampton, Greenwood and Coal Valley, plus a zone extending two miles beyond the boundaries of said municipalities.

The area within the municipalities of Galesburg and East Galesburg, plus a zone extending two miles beyond the boundaries of said municipalities.

The area within the municipalities of Bartonville, Peoria and Peoria Heights, plus a zone extending two miles beyond the boundaries of said municipalities.

The area within the municipalities of Pekin, North Pekin, Marquette Heights, Creve Coeur and East Peoria, plus a zone extending two miles beyond the boundaries of said municipalities.

The area within the municipalities of Bloomington and Normal, plus a zone extending two miles beyond the boundaries of said municipalities.

The area within the municipalities of Champaign, Urbana and Savoy, plus a zone extending two miles beyond the boundaries of said municipalities.

The area within the municipalities of Decatur, Mt. Zion, Harristown and Forsyth, plus a zone extending two miles beyond the boundaries of said municipalities.

The area within the municipalities of Springfield, Leland Grove, Jerome, Southern View, Grandview, Sherman and Chatham, plus a zone extending two miles beyond the boundaries of said municipalities.

The area within the townships of Godfrey, Foster, Wood River, Fort Russell, Chouteau, Edwardsville, Venice, Nameoki, Alton, Granite City and Collinsville located in Madison County; and the townships of Stites, Canteen, Centreville, Caseyville, St. Clair, Sugar Loaf and Stookey located in St. Clair County.

"Manufacturing Process": A process emission source or series of process emission sources used to convert raw materials, feed stocks, subassemblies or other components into a product, either for sale or for use as a component in a subsequent manufacturing process.

"Metal Furniture Coating": The application of a coating material to any furniture piece made of metal or any metal part which is or will be assembled with other metal, wood, fabric, plastic or glass parts to form a furniture piece including, but not limited to, tables, chairs, wastebaskets, beds, desks, lockers, benches, shelving, file cabinets, lamps and room dividers. This definition shall not apply to any coating line coating metal parts or products that is identified under the Standard Industrial Classification Code for Major Groups 33, 34, 35, 36, 37, 38, 39, 40 or 41.

"Miscellaneous Fabricated Product Manufacturing Process":

A manufacturing process involving one or more of the following applications, including any drying and curing of formulations, and capable of emitting volatile organic material:

Adhesives to fabricate or assemble non-furniture components or products

Asphalt solutions to paper or fiberboard

Asphalt to paper or felt

Coatings or dye to leather

Coatings to plastic

Coatings to rubber or glass

Curing of furniture adhesives in an oven which would emit in excess of 10 tons of volatile organic material per year if no air pollution control equipment were used

Disinfectant material to manufactured items

Plastic foam scrap or "fluff" from the manufacture of foam containers and packaging material to form resin pellets

Resin solutions to fiber substances

Rubber solutions to molds

Viscose solutions for food casings

The storage and handling of formulations associated with the process described above.

The use and handling of organic liquids and other substances for clean-up operations associated with the process described above.

"Miscellaneous Formulation Manufacturing Process":

A manufacturing process which compounds one or more of the following and is capable of emitting volatile organic material:

Adhesives

Asphalt solutions

Caulks, sealants or waterproofing agents

Coatings, other than paint and ink

Concrete curing compounds

Dyes

Friction materials and compounds

Resin solutions

Rubber solutions

Viscose solutions

The storage and handling of formulations associated with the process described above.

The use and handling of organic liquids and other substances for clean-up operations associated with the process described above.

"Miscellaneous Metal Parts and Products": For the purpose of 35 Ill. Adm. Code 215.204, miscellaneous metal parts and products shall include farm machinery, garden machinery, small appliances, commercial machinery, industrial machinery, fabricated metal products and any other industrial category which coats metal parts or products under the Standard Industrial Classification Code for Major Groups 33, 34, 35, 36, 37, 38 or 39 with the exception of the following: coating lines subject to 35 Ill. Adm. Code 215.204(a)-(i) and (k), automobile or light-duty truck refinishing, the exterior of marine vessels and the customized top coating of automobiles and trucks if production is less than thirty-five vehicles per day.

"Miscellaneous Organic Chemical Manufacturing Process":

A manufacturing process which produces by chemical reaction, one or more of the following organic compounds or mixtures of organic compounds and which is capable of emitting volatile organic materials:

Chemicals listed in 35 Ill. Adm. Code 215. Appendix D.

Chlorinated and sulfonated compounds

Cosmetic, detergent, soap or surfactant intermediaries or specialties and products

Disinfectants

Food additives

Oil and petroleum product additives

Plasticizers

Resins or polymers

Rubber additives

Sweeteners

Varnishes

The storage and handling of formulations associated with the process described above.

The use and handling of organic liquids and other substances for clean-up operations associated with the process described above.

"Mixing Operation": The operation of combining two or more ingredients, of which at least one is a grain.

"New Grain-Drying Operation": Any grain-drying operation the construction or modification of which is commenced on or after June 30, 1975.

"New Grain-Handling Operation": Any grain-handling operation the construction or modification of which is commenced on or after June 30, 1975.

"No Detectable Volatile Organic Material Emissions": A discharge of volatile organic material into the atmosphere as indicated by an instrument reading of less than 500 ppm above background as determined in accordance with 40 CFR 60.485(c).

"One Hundred Percent Acid": Acid with a specific gravity of 1.8205 at 30° C in the case of sulfuric acid and 1.4952 at 30° C in the case of nitric acid.

"One-Turn Storage Space": That space used to store grain with a total annual through-put not in excess of the total bushel storage of that space.

"Opacity": A condition which renders material partially or wholly impervious to transmittance of light and causes obstruction of an observer's view. For the purposes of these regulations, the following equivalence between opacity and Ringelmann shall be employed:

Opacity Percent	Ringelmann
10	0.5
20	1.
30	1.5
40	2.
60	3.
80	4.
100	5.

"Open Top Vapor Degreasing": The batch process of cleaning and removing soils from surfaces by condensing hot solvent vapor on the colder metal parts.

"Operator of Gasoline Dispensing Facility": Any person who is the lessee of or operates, controls or supervises a gasoline dispensing facility.

"Organic Compound": Any compound of carbon, excluding carbon monoxide, carbon dioxide, carbonic acid, metal carbides or carbonates, and ammonium carbonate.

"Organic Material": Any chemical compound of carbon including diluents and thinners which are liquids at standard conditions and which are used as solvers, viscosity reducers or cleaning agents, but excluding methane, carbon monoxide, carbon dioxide, carbonic acid, metallic carbonic acid, metallic carbide, metallic carbonates and ammonium carbonate.

"Organic Materials": For the purposes of Section 9.4 of the Act, any chemical compound of, carbon including diluents and thinners which are liquids at standard conditions and which are used as solvers, viscosity reducers or cleaning agents, and polychlorinated dibenzop-dioxins, polychlorinated dibenzofurans and polynuclear aromatic hydrocarbons are organic materials, while methane, carbon monoxide, carbon dioxide, carbonic acid, metallic carbonic acid, metallic carbide, metallic carbonates and ammonium carbonate are organic materials.

"Organic Vapor": Gaseous phase of an organic material or a mixture of organic materials present in the atmosphere.

"Overvarnish": A coating applied directly over ink or printing.

"Owner of Gasoline Dispensing Facility": Any person who has legal or equitable title to a stationary storage tank at a gasoline dispensing facility.

"Packaging Rotogravure Printing": Rotogravure printing upon paper, paper board, metal foil, plastic film and other substrates, which are, in subsequent operations, formed into packaging products or labels for articles to be sold.

"Paint Manufacturing Plant": A plant that mixes, blends, or compounds enamels, lacquers, sealers, shellacs, stains, varnishes or pigmented surface coatings.

"Paper Coating": The application of a coating material to paper or pressure sensitive tapes, regardless of substrate, including web coating on plastic fibers and decorative coatings on metal foil.

"Particulate Matter": Any solid or liquid material, other than water, which exists in finely divided form.

"Petroleum Liquid": Crude oil, condensate or any finished or intermediate product manufactured at a petroleum refinery, but not including Number 2 through

Number 6 fuel oils as specified in A.S.T.M. D-396-69, gas turbine fuel oils Numbers 2-GT through 4-GT as specified in A.S.T.M. D-2880-71 or diesel fuel oils Numbers 2-D and 4-D, as specified in A.S.T.M. D-975-68.

"Petroleum Refinery": Any facility engaged in producing gasoline, kerosene, distillate fuel oils, residual fuel oils, lubricants, or other products through distillation, cracking, extraction or reforming of unfinished petroleum derivatives.

"Pharmaceutical": Any compound or mixture, other than food, used in the prevention, diagnosis, alleviation, treatment or cure of disease in man and animal.

"Pharmaceutical Coating Operation": a device in which a coating is applied to a pharmaceutical, including any drying or curing of the coating.

"Photochemically Reactive Material": Any organic material with an aggregate of more than 20 percent of its total volume composed of the chemical compounds classified below or the composition of which exceeds any of the following individual percentage composition limitations. Whenever any photochemically reactive material or any constituent of any organic material may be classified from its chemical structure into more than one of the above groups of organic materials it shall be considered as a member of the most reactive group, that is, the group having the least allowable percent of the total organic materials.

A combination of hydrocarbons, alcohols, aldehydes, esters, ethers or ketones having an olefinic or cyclo-olefinic types of unsaturation: 5 percent. This definition does not apply to perchlorethylene or trichloroethylene.

A combination of aromatic compounds with eight or more carbon atoms to the molecule except ethylbenzene: 8 percent.

A combination of ethylbenzene, ketones having branched hydrocarbon structures or toluene: 20 percent.

"Plant": all of the pollutant-emitting activities which belong to the same industrial grouping, are located on one or more contiguous or adjacent properties, and are under the control of the same person (or persons under common control), except the activities of any marine vessel. Pollutant-emitting activities shall be

considered as part of the same industrial grouping if they belong to the same major group (i.e., which have the same two-digit code) as described in the "Standard Industrial Classification Manual", 1987.

"Pneumatic Rubber Tire Manufacture": The production of pneumatic rubber tires with a bead diameter up to but not including 20.0 inches and cross section dimension up to 12.8 inches, but not including specialty tires for antique or other vehicles when produced on equipment separate from normal production lines for passenger or truck type tires.

"Polybasic Organic Acid Partial Oxidation Manufacturing Process": Any process involving partial oxidation of hydrocarbons with air to manufacture polybasic acids or their anhydrides, such as maleic anhydride, phthalic anhydride, terephthalic acid, isophthalic acid, trimellitic anhydride.

"Portable Grain-Handling Equipment": Any equipment (excluding portable grain dryers) that is designed and maintained to be movable primarily for use in a non-continuous operation for loading and unloading one-turn storage space, and is not physically connected to the grain elevator, provided that the manufacturer's rated capacity of the equipment does not exceed 10,000 bushels per hour.

"Portland Cement Process": Any facility manufacturing portland cement by either the wet or dry process.

"Power Driven Fastener Coating": The coating of nail, staple, brad and finish nail fasteners where such fasteners are fabricated from wire or rod of 0.0254 inch diameter or greater, where such fasteners are bonded into coils or strips, such coils and strips containing a number of such fasteners, which fasteners are manufactured for use in power tools, and which fasteners must conform with formal standards for specific uses established by various federal and national organizations including Federal Specification FF-N-105b of the General Services Administration dated August 23, 1977 (does not include any later amendments or editions; U.S. Army Armament Research and Development Command, Attn: DRDAR-TST, Rock Island, IL 61201), Bulletin UM-25d of the U.S. Department of Housing and Urban Development - Federal Housing Administration dated September 5, 1973 (does not include any later amendments or editions; Department of HUD, 547 W. Jackson Blvd., Room 1005, Chicago, IL 60606), and the Model Building Code of the Council of American Building Officials, and similar standards. For the

purposes of this definition, the terms "brad" and "finish nail" refer to single leg fasteners fabricated in the same manner as staples. The application of coatings to staple, brad, and finish nail fasteners may be associated with the incremental forming of such fasteners in a cyclic or repetitious manner (incremental fabrication) or with the forming of strips of such fasteners as a unit from a band of wires (unit fabrication).

"PM-10": Particulate matter with an aerodynamic diameter equal to or less than 10 micrometers, as measured by the applicable test methods specified by rule. Ambient air concentrations for PM-10 are usually expressed in micrograms per cubic meter ($\mu\text{g}/\text{m}^3$).

"PPM (Vol) - (Parts per Million) (Volume)": A volume/volume ratio which expresses the volumetric concentration of gaseous air contaminant in a million unit volumes of gas.

"Pressure Release": The emission of materials resulting from system pressure being greater than set pressure of the pressure relief device.

"Pressure Tank": A tank in which fluids are stored at a pressure greater than atmospheric pressure.

"Prime Coat": The first film of coating material applied in a multiple coat operation.

"Prime Surfacer Coat": A film of coating material that touches up areas on the surface not adequately covered by the prime coat before application of the top coat.

"Process": Any stationary emission source other than a fuel combustion emission source or an incinerator.

"Process Unit": Components assembled to produce, as intermediate or final products, one or more of the chemicals listed in 35 Ill. Adm. Code 215. Appendix D. A process unit can operate independently if supplied with sufficient feed or raw materials and sufficient storage facilities for the product.

"Process Unit Shutdown": A work practice or operational procedure that stops production from a process unit or part of a process unit. An unscheduled work practice or operational procedure that stops production from a process unit or part of a process unit for less than 24 hours is not a process unit shutdown. The use of spare components and technically feasible bypassing of

components without stopping production is not a process unit shutdown.

"Process Weight Rate": The actual weight or engineering approximation thereof of all materials except liquid and gaseous fuels and combustion air, introduced into any process per hour. For a cyclical or batch operation, the process weight rate shall be determined by dividing such actual weight or engineering approximation thereof by the number of hours of operation excluding any time during which the equipment is idle. For continuous processes, the process weight rate shall be determined by dividing such actual weight or engineering approximation thereof by the number of hours in one complete operation, excluding any time during which the equipment is idle.

"Production Equipment Exhaust System": A system for collecting and directing into the atmosphere emissions of volatile organic material from reactors, centrifuges and other process emission sources.

"Publication Rotogravure Printing": Rotogravure printing upon paper which is subsequently formed into books, magazines, catalogues, brochures, directories, newspaper supplements or other types of non-packaging printed materials.

"Purged Process Fluid": Liquid or vapor from a process unit that contains volatile organic material and that results from flushing or cleaning the sample line(s) of a process unit so that an uncontaminated sample may then be taken for testing or analysis.

"Reactor": A vat, vessel or other device in which chemical reactions take place.

"Reasonably Available Control Technology (RACT)": The lowest emission limitation that an emission source is capable of meeting by the application of control technology that is reasonably available considering technological and economic feasibility.

"Refinery Fuel Gas": Any gas which is generated by a petroleum refinery process unit and which is combusted at the refinery, including any gaseous mixture of natural gas and fuel gas.

"Refinery Unit, Process Unit or Unit": A set of components which are a part of a basic process operation such as distillation, hydrotreating, cracking or reforming of hydrocarbons.

"Refrigerated Condenser": a surface condenser in which the coolant supplied to the condenser has been cooled by a mechanical device, other than by a cooling tower or evaporative spray cooling, such as a refrigeration unit or steam chiller unit.

"Residual Fuel Oil": Fuel oils of grade No. 4, 5 and 6 as specified in detailed requirements for fuel oils A.S.T.M. D-396-69 (1971).

"Restricted Area": The area within the boundaries of any "municipality" as defined in the Illinois Municipal Code, plus a zone extending one mile beyond the boundaries of any such municipality having a population of 1000 or more according to the latest federal census. (ch. 24, par 1-1-1 et seq.)

"Ringelmann Chart": The chart published and described in the Bureau of Mines, U.S. Department of Interior, Information Circular 8333 (Revision of IC7718) May 1, 1967, or any adaptation thereof which has been approved by the Agency.

"Roadway": Any street, highway, road, alley, sidewalk, parking lot, airport, rail bed or terminal, bikeway, pedestrian mall or other structure used for transportation purposes.

"Roll Printing": The application of words, designs and pictures to a substrate usually by means of a series of hard rubber or metal rolls each with only partial coverage.

"Rotogravure Printing": The application of words, designs and pictures to a substrate by means of a roll printing technique in which the pattern to be applied is recessed relative to the non-image area.

"Safety Relief Valve": A valve which is normally closed and which is designed to open in order to relieve excessive pressures within a vessel or pipe.

"Sandblasting": The use of a mixture of sand and air at high pressures for cleaning and/or polishing any type of surface.

"Sensor": A device that measures a physical quantity or the change in a physical quantity such as temperature, pressure, flow rate, pH, or liquid level.

"Set of Safety Relief Valves": One or more safety relief valves designed to open in order to relieve excessive pressures in the same vessel or pipe.

"Screening": Separating material according to size by pressing undersized material through one or more mesh surfaces (screens) in series, and retaining oversized material on the mesh surfaces (screens).

"Sheet Basecoat": A coating applied to metal when the metal is in sheet form to serve as either the exterior or interior of a can for either two-piece or three-piece cans.

"Shotblasting": The use of a mixture of any metallic or non-metallic substance and air at high pressures for cleaning and/or polishing any type of surface.

"Side-Seam Spray Coat": A coating applied to the seam of a three-piece can.

"Smoke": Small gas-borne particles resulting from incomplete combustion, consisting predominately but not exclusively of carbon, ash and other combustible material, that form a visible plume in the air.

"Smokeless Flare": A combustion unit and the stack to which it is affixed in which organic material achieves combustion by burning in the atmosphere such that the smoke or other particulate matter emitted to the atmosphere from such combustion does not have an appearance density or shade darker than No. 1 of the Ringlemann Chart.

"Solvent Cleaning": The process of cleaning soils from surfaces by cold cleaning, open top vapor degreasing or conveyORIZED degreasing.

"Specialty High Gloss Catalyzed Coating": Commercial contract finishing of material prepared for printers and lithographers where the finishing process uses a solvent-borne coating, formulated with a catalyst, in a quantity of no more than 12,000 gallons/year as supplied, where the coating machines are sheet fed and the coated sheets are brought to a minimum surface temperature of 190° F, and where the coated sheets are to achieve the minimum specular reflectance index of 65 measured at a 60 degree angle with a gloss meter.

"Splash Loading": A method of loading a tank, railroad tank car, tank truck or trailer by use of other than a submerged loading pipe.

"Stack": A flue or conduit, free-standing or with exhaust port above the roof of the building on which it is mounted, by which air contaminants are emitted into the atmosphere.

"Standard Conditions": A temperature of 70° F and a pressure of 14.7 pounds per square inch absolute (psia).

"Standard Cubic Foot (scf)": The volume of one cubic foot of gas at standard conditions.

"Startup": The setting in operation of an emission source for any purpose.

"Stationary Emission Source": An emission source which is not self-propelled.

"Stationary Storage Tank": Any container of liquid or gas which is designed and constructed to remain at one site.

"Submerged Loading Pipe": Any loading pipe the discharge opening of which is entirely submerged when the liquid level is 6 inches above the bottom of the tank. When applied to a tank which is loaded from the side, any loading pipe the discharge of which is entirely submerged when the liquid level is 18 inches or two times the loading pipe diameter, whichever is greater, above the bottom of the tank. The definition shall also apply to any loading pipe which is continuously submerged during loading operations.

"Sulfuric Acid Mist": Sulfuric acid mist as measured according to the method specified in 35 Ill. Adm. Code 214.101(b).

"Surface Condenser": A device which removes a substance from a gas stream by reducing the temperature of the stream, without direct contact between the coolant and the stream.

"Synthetic Organic Chemical or Polymer Manufacturing Plant": A plant that produces, as intermediates or final products, one or more of the chemicals or polymers listed in 35 Ill. Adm. Code 215.Appendix D.

"Tablet Coating Operation": A pharmaceutical coating operation in which tablets are coated.

"Top Coat": A film of coating material applied in a multiple coat operation other than the prime coat, final repair coat or prime surfacer coat.

"Transfer Efficiency": ratio of the amount of coating solids deposited onto a part or product to the total amount of coating solids used.

"Tread End Cementing": The application of a solvent-based cement to the tire tread ends.

"True Vapor Pressure": The equilibrium partial pressure exerted by a petroleum liquid as determined in accordance with methods described in American Petroleum Institute Bulletin 2517, "Evaporation Loss From Floating Roof Tanks" (1962).

"Turnaround": The procedure of shutting down an operating refinery unit, emptying gaseous and liquid contents to do inspection, maintenance and repair work, and putting the unit back into production.

"Undertread Cementing": The application of a solvent-based cement to the underside of a tire tread.

"Unregulated Safety Relief Valve": A safety relief valve which cannot be actuated by a means other than high pressure in the pipe or vessel which it protects.

"Vacuum Producing System": Any reciprocating, rotary or centrifugal blower or compressor, or any jet ejector or device that creates suction from a pressure below atmospheric and discharges against a greater pressure.

"Valves Not Externally Regulated": Valves that have no external controls, such as in-line check valves.

"Vapor Balance System": Any combination of pipes or hoses which creates a closed system between the vapor spaces of an unloading tank and a receiving tank such that vapors displaced from the receiving tank are transferred to the tank being unloaded.

"Vapor Collection System": All piping, seals, hoses, connections, pressure-vacuum vents, and other possible sources between the gasoline delivery vessel and the vapor processing unit and/or the storage tanks and vapor holder.

"Vapor Control System": Any system that prevents release to the atmosphere of organic material in the vapors displaced from a tank during the transfer of gasoline.

"Vapor-Mounted Primary Seal": A primary seal mounted with an air space bounded by the bottom of the primary seal, the tank wall, the liquid surface and the floating roof.

"Vinyl Coating": The application of a topcoat or printing to vinyl coated fabric or vinyl sheets.

"Volatile Organic Liquid": Any liquid which contains volatile organic material.

"Volatile Organic Material":

Any organic compound which participates in atmospheric photochemical reactions unless specifically exempted from this definition. For purposes of determining compliance with emission limits, volatile organic material shall be measured by the reference test methods incorporated by reference in 35 Ill. Adm. Code 215.105. Where such a method also inadvertently measures compounds with negligible photochemical reactivity, an owner or operator may exclude these negligibly reactive compounds.

For purposes of this definition, the following organic compounds have been determined to have negligible photochemical reactivity and are not volatile organic materials:

Chlorodifluoroethane (HCFC-142b)
 Chlorodifluoromethane (CFC-22)
 Chloropentafluoroethane (CFC-115)
 Dichlorodifluoromethane (CFC-12)
 Dichlorofluoroethane (HCFC-141b)
 Dichlorotetrafluoroethane (CFC-114)
 Dichlorotrifluoroethane (HCFC-123)
 Ethane
 Methane
 Dichloromethane (Methylene chloride)
 Tetrafluoroethane (HFC-134a)
 Trichloroethane (Methyl chloroform)
 Trichlorofluoromethane (CFC-11)
 Trichlorotrifluoroethane (CFC-113)
 Trifluoromethane (FC-23)

"Volatile Organic Material Content" or "VOMC": the emissions of volatile organic material which would result from the exposure of a coating, printing ink, fountain solution, tire spray, dry cleaning waste or other similar material to the air, including any drying or curing, in

the absence of any control equipment. VOMC is typically expressed as kilogram (kg) VOM/liter (lb VOM/gallon) of coating or coating solids, or kg VOM/kg (lb VOM/lb) of coating solids, of coating material or material.

"Volatile Petroleum Liquid": Any petroleum liquid with a true vapor pressure that is greater than 1.5 psia (78 millimeters of mercury) at standard conditions.

"Wastewater (Oil/Water) Separator": Any device or piece of equipment which utilizes the difference in density between oil and water to remove oil and associated chemicals of water, or any device, such as a flocculation tank or a clarifier, which removes petroleum derived compounds from waste water.

"Weak Nitric Acid Manufacturing Process": Any acid producing facility manufacturing nitric acid with a concentration of less than 70 percent by weight.

"Woodworking": The shaping, sawing, grinding, smoothing, polishing and making into products of any form or shape of wood.

(Source: Amended at 15 Ill. Reg. _____, effective _____)

TITLE 35: ENVIRONMENTAL PROTECTION
 SUBTITLE B: AIR POLLUTION
 CHAPTER I: POLLUTION CONTROL BOARD
 SUBCHAPTER c: EMISSION STANDARDS AND
 LIMITATIONS FOR STATIONARY SOURCES

PART 212
 VISIBLE AND PARTICULATE MATTER EMISSIONS

SUBPART A: GENERAL

Section	
212.100	Scope and Organization
212.107	<u>Measurement Method for Visible Emissions</u>
212.108	<u>Measurement Methods for PM-10 Emissions</u>
212.109	<u>Measurement Methods for Opacity</u>
212.110	<u>Measurement Methods For Particulate Matter</u>
212.111	Abbreviations and Units
212.112	Definitions
212.113	Incorporations by Reference

SUBPART B: VISIBLE EMISSIONS

Section	
212.121	Opacity Standards
212.122	Limitations for Certain New Sources
212.123	Limitations for All Other Sources
212.124	Exceptions
212.125	Determination of Violations
212.126	Adjusted Opacity Standards Procedures

SUBPART D: PARTICULATE MATTER EMISSIONS FROM INCINERATORS

Section	
212.181	Limitations for Incinerators
212.182	Aqueous Waste Incinerators
212.183	Certain Wood Waste Incinerators
212.184	Explosive Waste Incinerators
212.185	Continuous Automatic Stoking Animal Pathological Waste Incinerators

SUBPART E: PARTICULATE MATTER EMISSIONS
FROM FUEL COMBUSTION EMISSION SOURCES

Section	
212.201	Existing Sources Using Solid Fuel Exclusively Located in the Chicago Area
212.202	Existing Sources Using Solid Fuel Exclusively Located Outside the Chicago Area
212.203	Existing Controlled Sources Using Solid Fuel Exclusively
212.204	New Sources Using Solid Fuel Exclusively
212.205	Existing Coal-fired Industrial Boilers Equipped with Flue Gas Desulfurization Systems
212.206	Sources Using Liquid Fuel Exclusively
212.207	Sources Using More Than One Type of Fuel
212.208	Aggregation of Existing Sources
212.209	Village of Winnetka Generating Station

SUBPART K: FUGITIVE PARTICULATE MATTER

Section	
212.301	Fugitive Particulate Matter
212.302	Geographical Areas of Application
212.304	Storage Piles
212.305	Conveyor Loading Operations
212.306	Traffic Areas
212.307	Materials Collected by Pollution Control Equipment
212.308	Spraying or Choke-Feeding Required
212.309	Operating Program
212.310	Minimum Operating Program
212.312	Amendment to Operating Program
212.313	Emission Standard for Particulate Collection Equipment
212.314	Exception for Excess Wind Speed
212.315	Covering for Vehicles

212.316 Emission Limitations for Sources in Certain AreasSUBPART L: PARTICULATE MATTER EMISSIONS FROM PROCESS
EMISSION SOURCES

Section

- 212.321 New Process Sources
- 212.322 Existing Process Sources
- 212.323 Stock Piles
- 212.324 , Process Emission Sources in Certain Areas

SUBPART N: FOOD MANUFACTURING

Section

- 212.361 Corn Wet Milling Processes
- 212.362 Sources in Certain Areas

SUBPART O: PETROLEUM REFINING, PETROCHEMICAL AND
CHEMICAL MANUFACTURING

Section

- 212.381 Catalyst Regenerators of Fluidized Catalytic Converters

SUBPART Q: STONE, CLAY, GLASS AND CONCRETE MANUFACTURING

Section

- 212.421 New Portland Cement Processes
- 212.422 Portland Cement Manufacturing Processes
- 212.425 Sources in Certain Areas

SUBPART R: PRIMARY AND FABRICATED METAL PRODUCTS AND
MACHINERY MANUFACTURE

Section

- 212.441 Steel Manufacturing Processes
- 212.442 Beehive Coke Ovens
- 212.443 By-Product Coke Plants
- 212.444 Sinter Processes
- 212.445 Blast Furnace Cast Houses
- 212.446 Basic Oxygen Furnaces
- 212.447 Hot Metal Desulfurization Not Located in the BOF
- 212.448 Electric Arc Furnaces
- 212.449 Argon-Oxygen Decarburization Vessels
- 212.450 Liquid Steel Charging
- 212.451 Hot Scarfing Machines
- 212.452 Measurement Methods
- 212.455 Highlines on Steel Mills
- 212.456 Certain Small Foundries
- 212.457 Certain Small Iron-melting Air Furnaces
- 212.458 Sources in Certain Areas

SUBPART S: AGRICULTURE

Section
 212.461 Grain Handling and Drying in General
 212.462 Grain Handling Operations
 212.463 Grain Drying Operations
212.464 Sources in Certain Areas

SUBPART T: CONSTRUCTION AND WOOD PRODUCTS

Section
 212.681 Grinding, Woodworking, Sandblasting and Shotblasting

Appendix A Rule into Section Table
 Appendix B Section into Rule Table
 Appendix C Past Compliance Dates

Illustration A: Allowable Emissions from Solid Fuel
 Combustion Emission Sources Outside Chicago
 Illustration B: Limitations for all New Process Emission
 Sources
 Illustration C: Limitations for all Existing Process Emission
 Sources
Illustration D: McCook Vicinity Map
Illustration E: Lake Calumet Vicinity Map
Illustration F: Granite City Vicinity Map

AUTHORITY: Implementing Section 10 and authorized by Section 27 of the Environmental Protection Act (Ill. Rev. Stat. 1989, ch. 111 1/2, pars. 1010 and 1027).

SOURCE: Adopted as Chapter 2: Air Pollution, Rules 202 and 203: Visual and Particulate Emission Standards and Limitations, R71-23, 4 PCB 191, filed and effective April 14, 1972; amended in R77-15, 32 PCB 403, at 3 Ill. Reg. 5, p. 798, effective February 3, 1979; amended in R78-10, 35 PCB 347, at 3 Ill. Reg. 39, p. 184, effective September 28, 1979; amended in R78-11, 35 PCB 505, at 3 Ill. Reg. 45, p. 100, effective October 26, 1979; amended in R78-9, 38 PCB 411, at 4 Ill. Reg. 24, p. 514, effective June 4, 1980; amended in R79-11, 43 PCB 481, at 5 Ill. Reg. 11590, effective October 19, 1981; codified at 7 Ill. Reg. 13591; amended in R82-1 (Docket A), 10 Ill. Reg. 12637, effective July 9, 1986; amended in R85-33 at 10 Ill. Reg. 18030, effective October 7, 1986; amended in R84-48 at 11 Ill. Reg. 691, effective December 18, 1986; amended in R84-42 at 11 Ill. Reg. 1410, effective December 30, 1986; amended in R82-1 (Docket B) at 12 Ill. Reg. 12492, effective July 13, 1988; amended in R91-22 at 15 Ill. Reg. _____, effective _____.

SUBPART A: GENERAL

Section 212.107 Measurement Method for Visible Emissions

Detection of visible emissions from both process emission sources and fugitive particulate matter emission sources shall be conducted in accordance with Method 22, 40 CFR 60, Appendix A, incorporated by reference in Section 212.113, except that the length of the observing period shall be at the discretion of the observer, but not less than one minute.

(Source: Added at 15 Ill.Reg. _____, effective _____.)

Section 212.108 Measurement Methods for PM-10 Emissions

- a) Emissions of PM-10 shall be measured by any of the following methods at the option of the owner or operator of an emissions source.
 - 1) Method 201, 40 CFR 51, Appendix M, incorporated by reference in Section 212.113.
 - 2) Method 201A, 40 CFR 51, Appendix M, incorporated by reference in Section 212.113.
 - 3) Method 5, 40 CFR 60, Appendix A, incorporated by reference in Section 212.113, provided that all particulate matter measured by Method 5 shall be considered to be PM-10.
- b) The volumetric flow rate and gas velocity shall be determined in accordance with methods 1, 1A, 2, 2A, 2C, 2D, 3 or 4, 40 CFR 60 Appendix A, incorporated by reference in Section 212.113.
- c) Upon a written notification by the Illinois Environmental Protection Agency (Agency), the owner or operator of a PM-10 emission source subject to this Section shall conduct the applicable testing for PM-10 emissions, opacity, or visible emissions at such person's own expense, to demonstrate compliance. Such test results shall be submitted to the Agency within 30 days of conducting the test unless an alternative time for submittal is agreed to by the Agency.
- d) A person planning to conduct testing for PM-10 emissions to demonstrate compliance shall give written notice to the Agency of that intent. Such notification shall be given at least 30 days prior to initiation of the test unless a shorter pre-notification is agreed to by the Agency. Such notification shall state the specific test methods from subsection (a) that will be used.

- e) The owner or operator of an emission source subject to this Section shall retain records of all tests which are performed. These records shall be retained for at least three years after the date a test is performed.
- f) This Section shall not affect the authority of the United States Environmental Protection Agency under Section 114 of the Clean Air Act (42 U.S.C. § 7414 (1990)).

(Source: Added at 15 Ill. Reg. _____, effective _____.)

212.109 Measurement Methods for Opacity

Except as otherwise provided in this Part, and except for the methods of data reduction when applied to Sections 212.122 and 212.123, measurements of opacity shall be conducted in accordance with Method 9, 40 CFR Part 60, Appendix A, except that for roadways and parking areas the number of readings required for each vehicle pass will be three taken at 5-second intervals. The first reading shall be at the point of maximum opacity and second and third readings shall be made at the same point, the observer standing at right angles to the plume at least 15 feet and observing 4 feet above the surface of the roadway or parking area. After four vehicles have passed, the 12 readings will be averaged.

(Source: Added at 15 Ill. Reg. _____, effective _____.)

Section 212.110 Measurement Methods For Particulate Matter

Particulate matter emissions from stationary emission sources subject to this Part shall be conducted in accordance with Method 5, 5A, 5D, or 5E, 40 CFR Part 60, Appendix A, determined by the procedures incorporated by reference in Section 212.113 described in the American Society of Mechanical Engineers Power Test Code 27-1957 (Determining Dust Concentration in a Gas Stream) as revised from time to time, or by any other equivalent procedures approved by the Illinois Environmental Protection Agency (Agency).

(Source: Amended at 15 Ill. Reg. _____, effective _____.)

Section 212.113 Incorporations by Reference

The following materials are incorporated by reference. These incorporations do not include any later amendments or editions.

- ~~a) ASME Power Test Code 27-1957, Determining Dust Concentration in a Gas Stream, American Society of Mechanical Engineers, United Engineering Center, 345 E. 47th Street, New York, NY 10017.~~
- a)b) Ringelmann Chart, Information Circular 833 (Revision of IC7718), Bureau of Mines, U.S. Department of Interior, May 1, 1967.
- b)e) 40 CFR 60 (1990) ~~(1987)~~.
- c)d) ASAE Standard 248.2, Section 9, Basis for Stating Drying Capacity of Batch and Continuous-Flow Grain Dryers, American Society of Agricultural Engineers, 2950 Niles Road, St. Joseph, MI 49085.
- d)e) U.S. Sieve Series, ASTM-E11, American Society of Testing Materials, 1916 Race Street, Philadelphia, PA 19103.
- e) 40 CFR 51 (1990).
- f) ~~This Part incorporates no further editions or amendments.~~

(Source: Amended at 15 Ill. Reg. _____, effective _____.)

SUBPART K: FUGITIVE PARTICULATE MATTER

Section 212.302 Geographical Areas of Application

- a) Except for those operations subject to Subpart S (Grain-Handling and Grain-Drying Operations), Sections 212.304 through 212.310, and 212.312 shall apply to all mining operations (SIC major groups 10 through 14), manufacturing operations (SIC major groups 20 through 39), and electric generating operations (SIC group 491), which are located in the areas defined by the boundaries of the following townships, notwithstanding any political subdivisions contained therein, as the township boundaries were defined on October 1, 1979, in the following counties:

Cook:	All townships
Lake:	Shields, Waukegan, Warren
DuPage:	Addison, Winfield, York
Will:	DuPage, Plainfield, Lockport, Channahon, Peotone, Florence, Joliet
Peoria:	Richwoods, Limestone, Hollis, Peoria, City of Peoria

Tazewell: Fondulac, Pekin, Cincinnati, Groveland, Washington
 Macon: Decatur, Hickory Point
 Rock Island: Blackhawk, Coal Valley, Hampton, Moline, South Moline, Rock Island, South Rock Island
 LaSalle: LaSalle, Utica
 Madison: Alton, Chouteau, Collinsville, Edwardsville, Fort Russell, Godfrey, Granite City, Nameoki, Venice, Wood River
 St. Clair: Canteen, Caseyville, Centerville, St. Clair, Stites, Stookey, Sugar Loaf, Millstadt

b) Sections 212.304 through 212.310, 212.312 and 212.316 shall also apply to those areas defined in Section 212.324, and will apply to the following operations: grain-handling and grain-drying (Subpart S), transportation, communications, electric, gas, and sanitary services (SIC major groups 40 through 49) and those operations listed in subsection (a).

c) Compliance Date. The rules of this Section shall become effective one year following their effective date or December 10, 1993, whichever is earlier.

(Source: Amended at 15 Ill. Reg. _____, effective _____.)

Section 212.309 Operating Program

a) The sources described in Sections 212.304 through 212.308 and Section 212.316 shall be operated under the provisions of an operating program, consistent with the requirements set forth in Sections 212.310 and 212.312, and prepared by the owner or operator and submitted to the Agency for its review. Such operating program shall be designed to significantly reduce fugitive particulate matter emissions.

b) Compliance Date. The rules of this Section shall become effective one year following their effective date or December 10, 1993, whichever is earlier.

(Source: Amended at 15 Ill. Reg. _____, effective _____.)

Section 212.316 Emission Limitations For Sources in Certain Areas

- a) Applicability. This Section shall apply to those operations specified in Section 212.302 and that are located in areas defined in Section 212.324.
- b) Emission Limitation for Crushing and Screening Operations. No person shall cause or allow fugitive particulate matter emissions generated by the crushing or screening of slag, stone, coke or coal to exceed an opacity of 10%.
- c) Emission Limitations for Roadways or Parking Areas. No person shall cause or allow fugitive particulate matter emissions from any roadway or parking area to exceed an opacity of 10%, except that the opacity shall not exceed 5% at quarries with a capacity to produce more than 1 million tons per year of aggregate.
- d) Emission Limitations for Storage Piles. No person shall cause or allow fugitive particulate matter emissions from any storage pile to exceed an opacity of 10%, to be measured four feet from the pile surface.
- e) Emission Limitation for All Other Sources. Unless a source has been assigned a particulate matter, PM-10, or fugitive particulate matter emissions limitation elsewhere in this Section or in Subparts R or S, no person shall cause or allow fugitive particulate matter emissions from any source to exceed an opacity of 20%.
- f) Recordkeeping and Reporting
 - 1) The owner or operator of any fugitive particulate matter emission source subject to this Section shall keep written records of the application of control measures as may be needed for compliance with the opacity limitations of this Section and shall submit to the Agency an annual report containing a summary of such information.
 - 2) The records required under this subsection shall include at least the following:
 - A) the name and address of the plant;
 - B) the name and address of the owner and/or operator of the plant;
 - C) a map or diagram showing the location of all emission sources controlled including the location, identification, length, and width of roadways;

- D) for each application of water or chemical solution to roadways by truck: the name and location of the roadway controlled, application rate of each truck, frequency of each application, width of each application, identification of each truck used, total quantity of water or chemical used for each application and, for each application of chemical solution, the concentration and identity of the chemical;
 - E) for application of physical or chemical control agents, the name of the agent, application rate and frequency, and total quantity of agent and, if diluted, percent of concentration, used each day; and
 - F) a log recording incidents when control measures were not used and a statement of explanation.
- 3) Copies of all records required by this Section shall be submitted to the Agency within ten (10) working days of a written request by the Agency and shall be transmitted to the Agency by a company-designated person with authority to release such records.
 - 4) The records required under this Section shall be kept and maintained for at least three (3) years and shall be available for inspection and copying by Agency representatives during working hours.
 - 5) A quarterly report shall be submitted to the Agency stating the following: the dates any necessary control measures were not implemented, a listing of those control measures, the reasons that the control measures were not implemented, and any corrective actions taken. This information includes, but is not limited to, those dates when a reasonable person would believe that the application of such control measures would be unreasonable given prevailing atmospheric conditions. This report shall be submitted to the Agency 30 calendar days from the end of a quarter. Quarters end March 31, June 30, September 30, and December 31.
- g) Compliance Date. The rules of this Section shall become effective one year following their effective date or December 10, 1993, whichever is earlier.

(Source: Added at 15 Ill. Reg. _____, effective _____.)

SUBPART L: PARTICULATE MATTER EMISSIONS FROM
PROCESS EMISSION SOURCES

Section 212.324 Process Emission Sources in Certain Areas

a) Applicability.

- 1) This Section shall apply to any process emission source located in any of the following areas:
 - A) That area bounded by lines from Universal Transmercator (UTM) coordinate 428000mE, 4631000mN, east to 435000mE, 4631000mN, south to 435000mE, 4623000mN, west to 428000mE, 4623000mN, north to 428000mE, 4631000mN, in the vicinity of McCook in Cook County, as shown in Illustration D;
 - B) That area bounded by lines from Universal Transmercator (UTM) coordinate 445000mE, 4622180mN, east to 456265mE, 4622180mN, south to 456265E, 4609020N, west to 445000mE, 4609020mN, north to 445000mE, 4622180mN, in the vicinity of Lake Calumet in Cook County, as shown in Illustration E; and
 - C) That area bounded by lines from Universal Transmercator (UTM) coordinate 744000mE, 4290000mN, east to 753000mE, 4290000mN, south to 753000mE, 4283000mN, west to 744000mE, 4283000mN, north to 744000mE, 4290000mN, in the vicinity of Granite City in Madison County, as shown in Illustration F.
- 2) This Section shall not alter the applicability of Sections 212.321 and 212.322.
- 3) This Section is not applicable to any source subject to a specific emissions standard or limitation contained in any of the following Subparts:
 - i) Subpart N, Food Manufacturing;
 - ii) Subpart O, Stone, Clay, Glass and Concrete Manufacturing;
 - iii) Subpart R, Primary and Fabricated Metal Products and Machinery Manufacture; and

iv) Subpart S, Agriculture.

b) General Emission Limitation. Except as otherwise provided in this Part, no person shall cause or allow the emission of PM-10, other than that of fugitive particulate matter, into the atmosphere from any process emission source to exceed 68.7 mg/scm (0.03 gr/scf) during any one hour period.

c) Alternative Emission Limitation. The emission limit of 68.7 mg/scm (0.03 gr/scf) contained in subsection (b) shall not apply to the following sources for which alternative emission limits are provided below:

<u>Source</u>	<u>Emissions Limit Metric</u>	<u>English</u>
<u>1) Shotblasting emissions sources in the Village of McCook equipped with fabric filter(s) as of June 1, 1991</u>	<u>22.9 mg/scm</u>	<u>0.01 gr/scf</u>
<u>2) Cold rolling mill emissions sources at metal finishing plants located in the Village of McCook</u>	<u>45.8 mg/scm</u>	<u>0.02 gr/scf</u>
<u>3) Any annealing furnace at metal finishing plants located in the Village of McCook</u>	<u>45.8 mg/scm</u>	<u>0.02 gr/scf</u>
<u>4) All process emissions sources at manufacturers of steel wool with soap pads located in the Village of McCook</u>	<u>5% opacity</u>	<u>5% opacity</u>

d) Exceptions. The emission limits contained in subsections (b) and (c) shall not apply to those sources with no visible emissions.

e) Maintenance and Repair. For any process emission source subject to subsection (a), the owner or operator shall maintain and repair all air pollution control equipment in a manner that assures that the emission limits and standards in this Section shall be met at all times. This Section shall not affect the

applicability of Section 201.149. Proper maintenance shall include the following minimum requirements:

- 1) Visual inspections of air pollution control equipment;
- 2) Maintenance of an adequate inventory of spare parts; and
- 3) Expeditious repairs, unless the source is shutdown.

f) Recordkeeping of Maintenance and Repair.

- 1) Written records of inventory and documentation of inspections, maintenance, and repairs of all air pollution control equipment shall be kept in accordance with subsection (e).
- 2) The owner or operator shall document any period during which any process emission source was in operation when the air pollution control equipment was not in operation or was malfunctioning so as to cause an emissions level in excess of the emissions limitation. These records shall include documentation of causes for pollution control equipment not operating or such malfunction and shall state what corrective actions were taken and what repairs were made.
- 3) A written record of the inventory of all spare parts not readily available from local suppliers shall be kept and updated.
- 4) Copies of all records required by this Section shall be submitted to the Agency within ten (10) working days of a written request by the Agency.
- 5) The records required under this Section shall be kept and maintained for at least three (3) years and shall be available for inspection and copying by Agency representatives during working hours.
- 6) Upon written request by the Agency a report shall be submitted to the Agency for any period specified in the request stating the following: the dates during which any process emissions source was in operation when the air pollution control equipment was not in operation or was not operating properly, documentation of causes for pollution control equipment not operating or not operating properly, and a statement of what

corrective actions were taken and what repairs were made.

- g) Compliance Date. The rules of this Section shall become effective one year following their effective date or December 10, 1993, whichever is earlier.

(Source: Added at 15 Ill. Reg. _____, effective _____.)

SUBPART N: FOOD MANUFACTURING

212.362 Sources in Certain Areas

- a) Applicability. Section 212.361 notwithstanding, this Section shall apply to those sources engaged in food manufacturing and located in the Village of Bedford Park west of Archer Avenue and in the area defined in Section 212.324(a)(1).
- b) Emission Limitation. No person shall cause or allow the emission of PM-10, other than that of fugitive particulate matter, into the atmosphere to exceed the following limits during any one hour period:
- 1) 22.9 mg/scm (0.01 gr/scf) for dextrose dryers, dextrose melt tank systems, bulk dextrose loading system, house dry dextrose dust system, dextrose bagging machine dust system; dextrose expansion dryer/cooler and 2034 dextrose dryer/cooler dust collecting system;
 - 2) 34.3 mg/scm (0.015 gr/scf) for feed dryers, gluten dryers, germ dryers;
 - 3) 68.7 mg/scm (0.03 gr/scf) for germ cake transport systems, spent flake transport/cooling systems, bleaching clay system, B26 dust pickup bin system, and pellet cooler systems; and
 - 4) 45.8 mg/scm (0.02 gr/scf) for germ transport systems, starch dust collections system, dicalite system, starch processing/transport systems, starch dryers, starch transport systems, calcium carbonate storage system, starch loading systems, corn unloading systems, germ transfer towers, dextrose transport systems, soda ash unloading system, corn silo system, filter aid systems, spent flake storage systems, corn cleaning transport systems, feed transport cooling system, gluten cooling system, gluten transport system, feed dust system, gluten dust system, pellet dust

system, spent flake transport system, and rail car maintenance system.

- c) Exceptions. The emission limits contained in subsection (b) shall not apply to those sources with no visible emissions.
- d) Maintenance, Repair, and Recordkeeping. The requirements of subsections (e) and (f) of Section 212.324 shall also apply to this Section.
- e) Compliance Date. The rules of this Section shall become effective one year following their effective date or December 10, 1993, whichever is earlier.

(Source: Added at 15 Ill. Reg. _____, effective _____.)

SUBPART Q: STONE, CLAY, GLASS AND CONCRETE MANUFACTURING

212.425 Sources in Certain Areas

- a) Applicability. This Section shall apply to those sources located in those areas defined in Section 212.324(a)(1).
- b) Emission Limitation. No person shall cause or allow the emission of PM-10, other than that of fugitive particulate matter, into the atmosphere to exceed the following limits during any one hour period:
 - 1) 57.2 mg/scm (0.025 gr/scf) for coater and cooling loop ventilator at roofing asphalt manufacturing plant located in the Village of Summit;
 - 2) 34.3 mg/scm (0.015 gr/scf) for mineral filler handling sources at roofing asphalt manufacturing plant located in the Village of Summit;
 - 3) 0.03 kg/Mg (0.06 lb/T) of PM-10 per ton of asphalt mixed for asphalt mixer at roofing asphalt manufacturing plant located in the Village of Summit;
 - 4) 91.6 mg/scm (0.04 gr/scf) for roofing asphalt blowing stills, except stills Nos. 1 and 2, at roofing asphalt manufacturing plant located in the Village of Summit;
 - 5) 45.8 mg/scm (0.02 gr/scf) for kilns in lime manufacturing industry;

- 6) 22.9 mg/scm (0.01 gr/scf) for all other process emission sources in lime manufacturing industry; and
- 7) 0.325 kg/Mg (0.65 lb/T) of PM-10 of glass produced for all glass melting furnaces.
- c) Exceptions. The emission limits contained in subsection (b) shall not apply to those sources with no visible emissions.
- d) Maintenance, Repair, and Recordkeeping. The requirements of subsections (e) and (f) of Section 212.324 shall also apply to this Section.
- e) Compliance Date. The rules of this Section shall become effective one year following their effective date or December 10, 1993, whichever is earlier.

(Source: Added at 15 Ill. Reg. _____, effective _____.)

SUBPART R: PRIMARY AND FABRICATED METAL PRODUCTS
AND MACHINERY MANUFACTURE

212.458 Sources in Certain Areas

- a) Applicability. This Section shall apply to those sources located in those areas defined in Section 212.324(a)(1).
- b) Emission Limitation. No person shall cause or allow emissions of PM-10, other than that of fugitive particulate matter, into the atmosphere to exceed the following limits during any one hour period:
 - 1) 15.9 ng/J (0.037 lbs. per mmbtu) of PM-10 of heat input from any fuel combustion source located at steel plant between 106th and 111th Streets in City of Chicago;
 - 2) 22.9 mg/scm (0.01 gr/scf) for basic oxygen furnace additive systems in the Village of Riverdale;
 - 3) 4.3 ng/J (0.01 lbs. per mmbtu) of PM-10 of heat input from the burning of fuel in the soaking pits in the Village of Riverdale;
 - 4) 38.9 mg/scm (0.17 gr/scf) from the primary stack of basic oxygen process in the Village of Riverdale;

- 5) 22.9 mg/scm (0.01 gr/scf) from the secondary stack of basic oxygen process in the Village of Riverdale;
 - 6) 45.8 mg/scm (0.02 gr/scf) from the pickling process at a steel plant in the Village of Riverdale; and
 - 7) 5% opacity for coal handling systems equipped with fabric filter(s) at steel plants located in the City of Chicago.
- c) Exceptions. The emission limits contained in subsection (b) shall not apply to those sources with no visible emissions.
 - d) Maintenance, Repair, and Recordkeeping. The requirements of subsections (e) and (f) of Section 212.324 shall also apply to this Section.
 - e) Compliance Date. The rules of this Section shall become effective December 10, 1993.

(Source: Added at 15 Ill. Reg. _____, effective _____.)

SUBPART S: AGRICULTURE

Section 212.464 Sources in Certain Areas

- a) Applicability. Notwithstanding Section 212.461, this Section shall apply to those sources located in the Lake Calumet area as defined in Section 212.324(a)(1).
- b) Emission Limitation.
 - 1) No person shall cause or allow the emission of PM-10, other than that of fugitive particulate matter, into the atmosphere to exceed 22.9 mg/scm (0.01 gr/scf) during any one hour period from any process emissions source engaged in the drying, receiving, shipping, transferring, storing, mixing or treating of grain, except column grain dryers and truck or rail unloading systems;
 - 2) No person shall cause or allow the emission of PM-10 into the atmosphere to exceed an opacity of 5% from truck or rail unloading systems;
 - 3) Column grain dryers shall not be eligible for the exemption as provided in Section 212.461(g).

- c) Exceptions. The emission limits contained in subsection (b) shall not apply to those sources with no visible emissions.
- d) Maintenance, Repair, and Recordkeeping. The requirements of subsections (e) and (f) of Section 212.324 shall also apply to this Section.
- e) Compliance Date. The rules of this Section shall become effective one year following their effective date or December 10, 1993, whichever is earlier.

(Source: Added at 15 Ill. Reg. _____, effective _____.)

Illustration D: McCook Vicinity Map

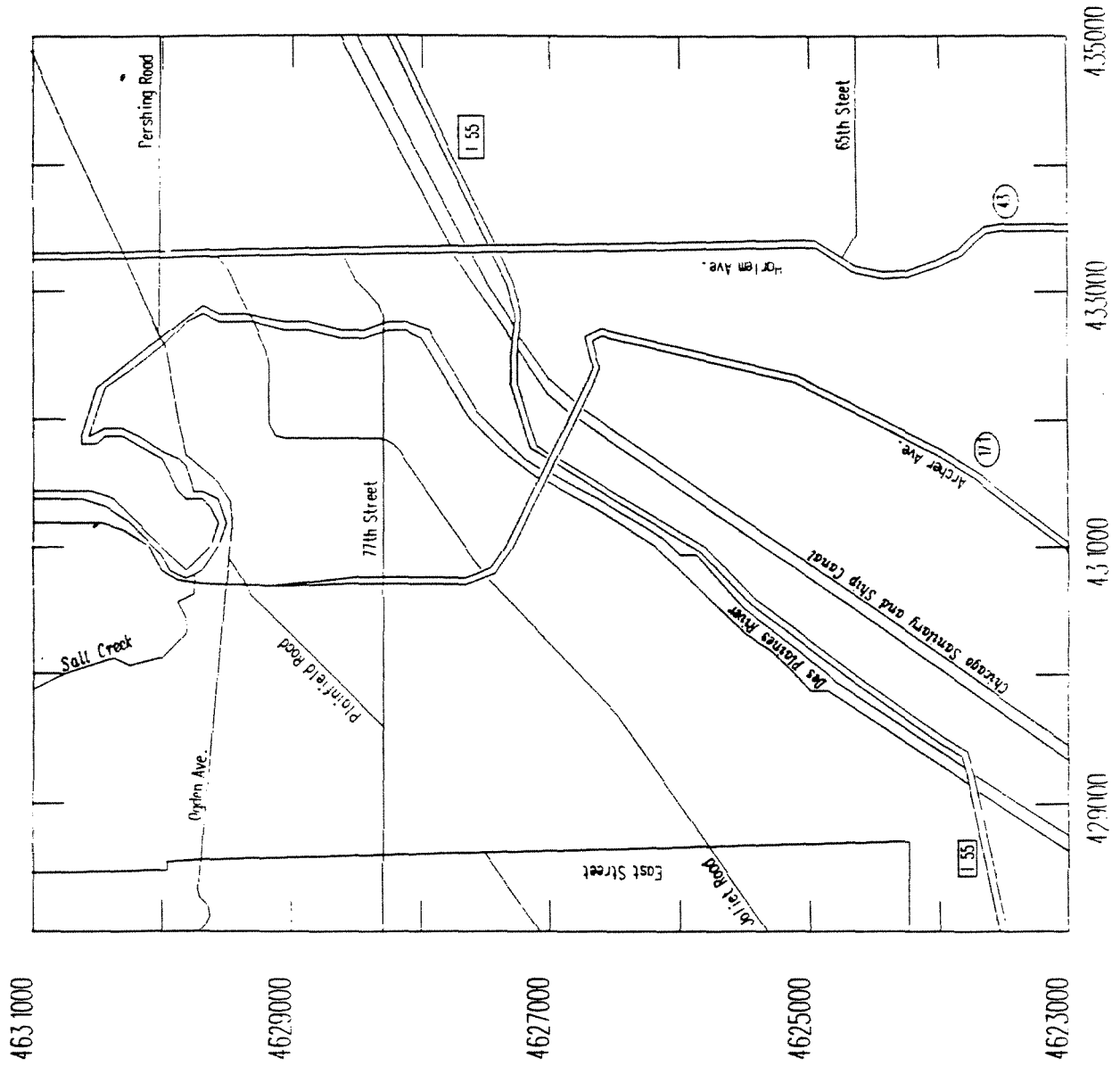

125-588

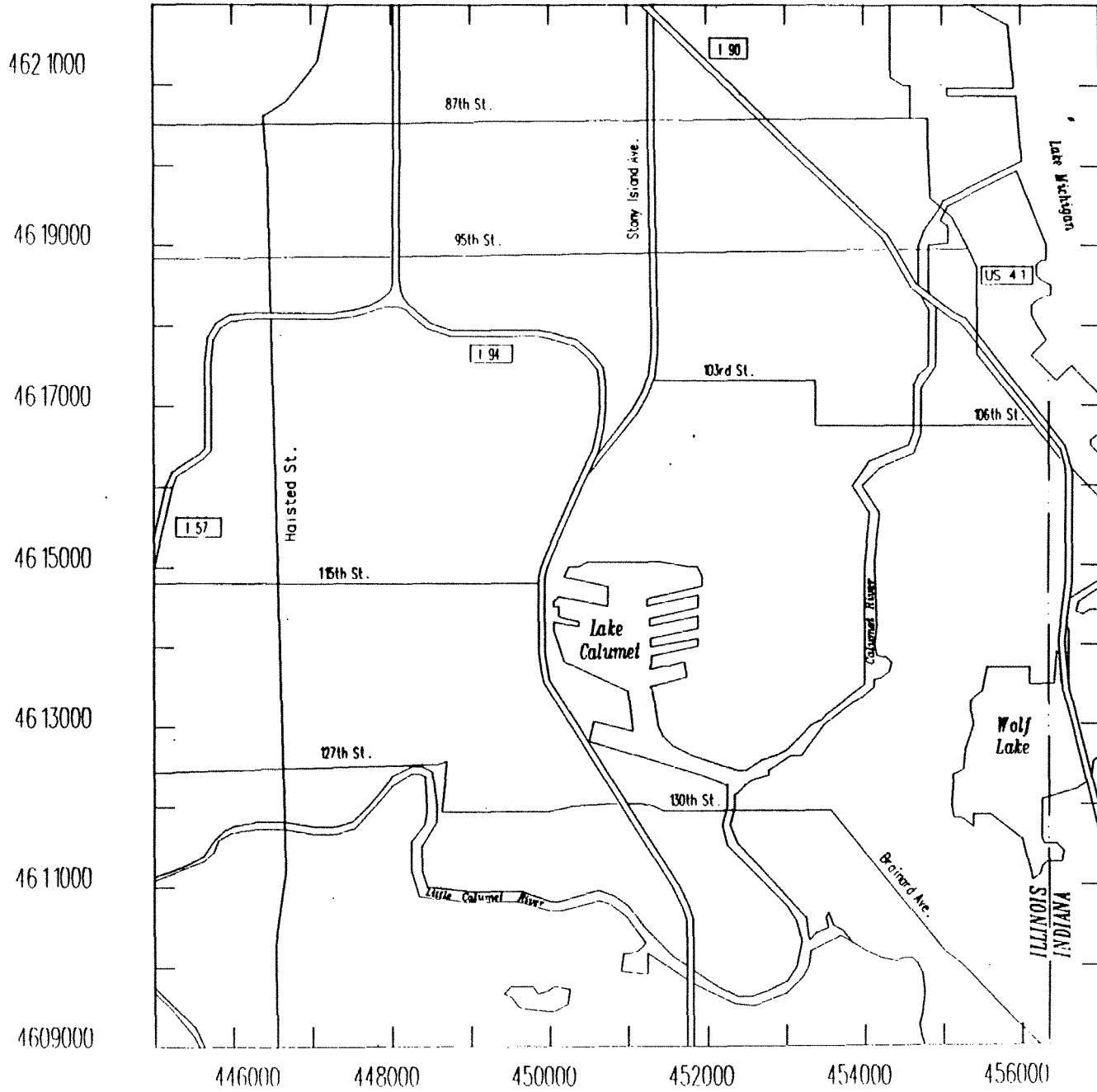

Illustration E: Lake Calumet Vicinity Map

125-589

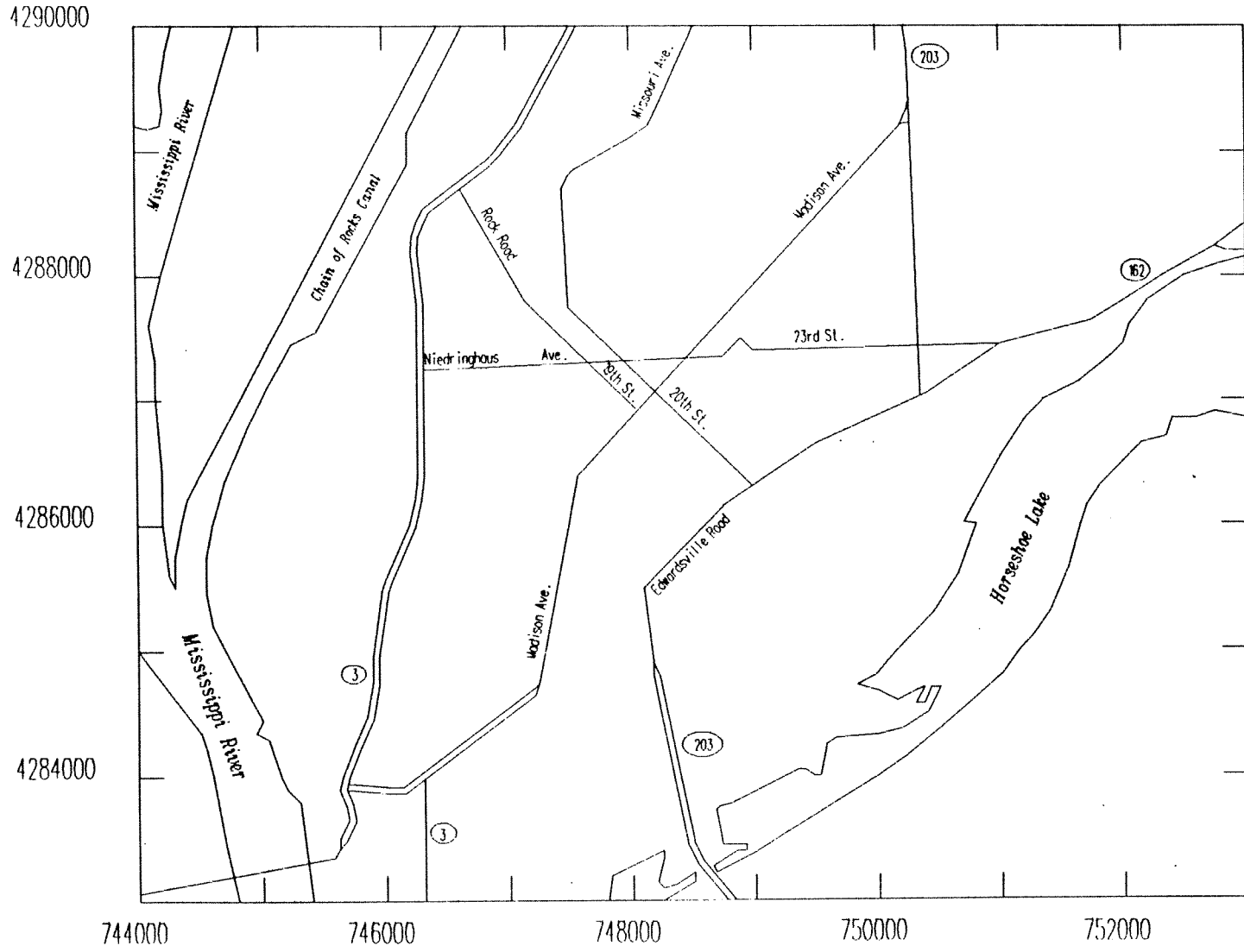
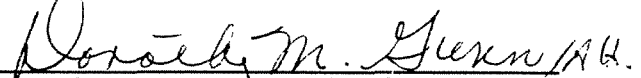

Illustration F: Granite City Vicinity Map

I, Dorothy M. Gunn, Clerk of the Illinois Pollution Control Board, hereby certify that the above Opinion and Order was adopted on the 26th day of August, 1991, by a vote of 7-0.

Dorothy M. Gunn, Clerk
Illinois Pollution Control Board