

**BEFORE THE ILLINOIS POLLUTION CONTROL BOARD**

England Farms, Inc.	)	
(Property Identification Number	)	PCB No. 26 -
19-05-100-005)	)	(Tax Certification)
	)	

**NOTICE**

**PLEASE TAKE NOTICE** that I have today filed with the Office of the Clerk of the Pollution Control Board an **APPEARANCE** and **RECOMMENDATION OF THE ILLINOIS ENVIRONMENTAL PROTECTION AGENCY**, copies of which are herewith served upon you.

England Farms, Inc.  
Jean S. England - Trustee  
576 Knox Road 1300 E  
Maquon, Illinois 61458

Don Brown, Clerk  
Illinois Pollution Control Board  
60 E. Van Buren St., Ste. 630  
Chicago, Illinois 60605

**Copies also provided electronically as follows:**

Illinois Department of Revenue  
via email at REV.PropTaxApp@illinois.gov  
101 West Jefferson  
P.O. Box 19033  
Springfield, Illinois 62794

ILLINOIS ENVIRONMENTAL PROTECTION AGENCY

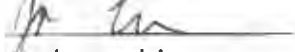
By:   
Joshua Leopold  
Assistant Counsel  
Division of Legal Counsel

DATED: November 7, 2025

Illinois Environmental Protection Agency  
2520 W Iles Ave.  
P.O. Box 19276  
Springfield, Illinois 62794-9276  
(217) 782-5544

**BEFORE THE ILLINOIS POLLUTION CONTROL BOARD**

England Farms, Inc.	)	
(Property Identification Number	)	PCB No. 26-
19-05-100-005)	)	(Tax Certification)
	)	

**A P P E A R A N C E**

The undersigned, as one of its attorneys, hereby enters an **APPEARANCE** on behalf of Respondent, Illinois Environmental Protection Agency.

ILLINOIS ENVIRONMENTAL PROTECTION AGENCY

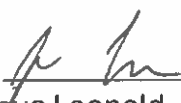
By:   
Joshua Leopold  
Assistant Counsel  
Division of Legal Counsel

DATED: November 7, 2025

Illinois Environmental Protection Agency  
2520 W Iles Ave.  
P.O. Box 19276  
Springfield, Illinois 62794-9276  
(217)782-5544

**BEFORE THE ILLINOIS POLLUTION CONTROL BOARD**

England Farms, Inc.	)	
(Property Identification Number	)	PCB No. 26-
19-05-100-005)	)	(Tax Certification)
	)	

**RECOMMENDATION OF THE ILLINOIS  
ENVIRONMENTAL PROTECTION AGENCY**

The Illinois Environmental Protection Agency ("Illinois EPA") hereby files its Recommendation pursuant to Section 125.204 of the regulations of the Illinois Pollution Control Board ("Board"), 35 Ill. Adm. Code 125.204.

1. On July 23, 2019, the Illinois EPA received a request from Jean S. England - Trustee (Log number TC-141525, Exhibit A) for an Illinois EPA recommendation regarding the tax certification of water pollution control facilities pursuant to 35 Ill. Adm. Code 125.204.
2. The facility's address is: England Farms, Inc.  
593 Knox Road 1300 E  
Maquon, Illinois 61458

The proposed water pollution control facilities in this request are located in the NW ¼ of Section 5, T9N, R3E of the 4<sup>th</sup> P.M. in Knox County, at the above street address and consist of the following livestock waste management structures:

One (1) concrete manure pit measuring 109 ft. (length) x 41 ft. (width) x 8 ft. (depth), concrete slatted flooring over the manure pit, and the length of perimeter drainage pipe described as 4in. x 8 in. plastic Form-A-Drain around the entire perimeter of above described building and the 200 ft. (length) of 4 in. (diameter) corrugated plastic drainage pipe allowing for drainage of groundwater.

These livestock waste management facilities are used to collect, transport and/or store livestock waste prior to cropland application.

3. Section 11-10 of the Property Tax Code, 35 ILCS 200/11-10 (2024), and Section 125.200(a) of the Board's regulations, 35 Ill. Adm. Code 125.200(a), define "pollution control facilities" as:

any system, method, construction, device or appliance appurtenant thereto or any portion of any building or equipment, that is designed, constructed, installed or operated for the primary purpose of: eliminating, preventing, or reducing air or water pollution ...or treating, pretreating, modifying or disposing of any potential solid, liquid or gaseous pollutant which if released without treatment, pretreatment modification or disposal might be harmful, detrimental or offensive to human, plant or animal life, or to property.

4. In order to receive preferential tax treatment as pursuant to 35 ILCS 200/11-5 (2024), pollution control facilities must be certified as such by the Board, 35 ILCS 200/11-20 (2024) and 35 Ill. Adm. Code 125.200(a).
5. Upon receipt of a tax certification application, the Illinois EPA must file a recommendation on the application with the Board, 35 Ill Adm. Code 125.204(a).
6. Based on the information in the application and the purpose of the facility, it is the Illinois EPA's engineering judgment that the described facilities may be considered "pollution control facilities," pursuant to 35 Ill. Adm. Code 125.200(a), with the primary purpose of eliminating, preventing, or reducing water pollution, or as otherwise provided in 35 Ill. Adm. Code 125.200, and are eligible for tax certification from the Board.

WHEREFORE, the Illinois EPA recommends that the Board issue the requested tax certification.

ILLINOIS ENVIRONMENTAL PROTECTION AGENCY

By:   
Joshua Leopold  
Assistant Counsel  
Division of Legal Counsel

Dated: November 7, 2025

Illinois Environmental Protection Agency  
2520 W Iles Ave.  
P.O. Box 19276  
Springfield, Illinois 62794-9276  
217/782-5544



# Illinois Environmental Protection Agency

2520 West Iles Avenue • P.O. Box 19276 • Springfield, Illinois • 62794-9276 • 217-782-3397

JB Pritzker, Governor

James Jennings, Acting Director

## Memorandum

To: Mike Roubitchek, Division of Legal Counsel

From: Darin LeCrone, P.E., Manager, Permit Section, Division of Water Pollution Control, Illinois Environmental Protection Agency

A handwritten signature in dark ink, appearing to read "DL", is written over the name Darin LeCrone.

Date: OCT 08 2025

Re: England Farms, Inc.  
Recommendation of Tax Certification  
Log No.: TC-141525  
BOW ID No.: W0958100002  
Property Index Number(s): 19-05-100-005

The Bureau of Water received a request on July 23, 2019, from Jean S. England Trustee, having a principal place of business at 576 Knox Road 1300 E, Maquon, IL 61458, for an Illinois EPA recommendation regarding the tax certification of water pollution control facilities pursuant to 35 Ill. Adm. Code 125.204. We offer the following recommendation.

The water pollution control facilities in this request include the following:

England Farms, Inc.  
593 Knox Road 1300 E  
Knox, IL 61458

NW ¼ of Section 5, T9N, R3E, of the 4<sup>th</sup> Principal Meridian in Knox County

Livestock waste handling facilities consist of:

One (1) concrete manure pit measuring 109 ft. (length) x 41 ft. (width) x 8 ft. (depth), concrete slatted flooring over the manure pit, and the length of perimeter drainage pipe described as 4 in. x 8 in. plastic Form-A-Drain around the entire perimeter of above described building and the 200 ft. (length) of 4 in. (diameter) corrugated plastic drainage pipe allowing for drainage of groundwater.

2125 S. First Street, Champaign, IL 61820 • 217-278-5800  
1101 Eastport Plaza Dr., Suite 100, Collinsville, IL 62234 • 618-346-5120  
595 S. State Street, Elgin, IL 60123 • 847-608-3131  
412 SW Washington Street, Suite D, Peoria, IL 61602 • 309-671-3022

115 S. LaSalle Street, Suite 2203, Chicago, IL 60603  
9511 Harrison Street, Des Plaines, IL 60016 • 847-294-4000  
2309 W. Main Street, Suite 116, Marion, IL 62959 • 618-993-7200  
4302 N. Main Street, Rockford, IL 61103 • 815-987-7760

Please print on recycled paper.

Page No. 2

Tax Certification Recommendation

Log No. TC-141525

These livestock waste management facilities collect, transport, and/ or store livestock waste prior to cropland application.

The facilities are further described in the enclosed applications and supporting documents.

Based on the information included in this submittal, it is our engineering judgment that the above proposed facilities may be considered "Pollution Control Facilities" under 35 Ill. Adm. Code 125.200(a), with the primary purpose of eliminating, preventing, or reducing water pollution, or as otherwise provided in this section, and therefore eligible for tax certification from the Illinois Pollution Control Board. The Bureau of Water therefore recommends that the Board issue the requested tax certification for these facilities.

If you have any questions regarding this letter, please contact Sarah Coulton at 217/782-0610.

SC:TC-141525\_Tax Cert Recommendation\_11Sept25.docx

cc: Tax Cert File  
Todd Bennett

Illinois EPA - Bureau of Water - Division of Pollution Control  
Title 35 Subtitle A Part 125 Tax Certifications  
Illinois EPA Review Notes for:  
**Agency Recommendation of Pollution Control Facilities.**

---

**BOW ID #:** W0958100002

**Project Name:** England Farms, Inc.

**Date application received:** 07/23/2019

**Reviewer:** SC

**Log number:** TC-141525

**Legal Description:**  
NW 5 ¼ Section Twp: 9N Range: 3E PM: 4

**County:** Knox

**Facility Contact:** Daniel S. England  
1368 Knox Road 140 N  
Maquon, IL 61458

**Phone:** 309-875-3482  
dsengland@mymctc.net

**Pollution Control Facility Type:**  
Swine Livestock Waste Management Facility

**Property ID:** 19-05-100-005

**Applicant:** Jean S. England Trustee  
576 Knox Road 1300 E  
Maquon, IL 61458

**Facility:** England Farms, Inc.  
593 Knox Road 1300 E  
Knox, IL 61458

**Date Control Devices installed:** 10/1/2015

**Application Signature by:** Daniel S. England

**Title:** Owner

Contents of Application: Application forms, specs, map

Is there a pollutant control flow diagram? **No**

Is there sufficient diagrams showing the pollution control facilities? **Yes**

**This facility generates the following pollutants and prevents their discharge as indicated:**  
**Livestock waste is collected and land applied to cropland.**

**Physical description of pollution control facilities that ARE recommended:**

The livestock waste handling facilities consist of one (1) concrete manure deep pit (approximately 109 ft. x 41 ft. x 8 ft.) and concrete slatted flooring over the manure pit. The deep pit has a plastic perimeter drain called Form-A-Drain (approximately 200 ft. + perimeter of building x 8 in. x 4 in.).

The facility collects, transports and stores livestock waste prior to cropland application.

Pollution control facilities requested by the Applicant through Description of Pollution Control Facilities, Section 2 of the application form and the attachments:

One (1) concrete manure pit,  
Concrete slatted floor, and  
one (1) plastic perimeter drain,

Illinois EPA Log #: TC-141525

Page 2 of 2

A map is provided by the attachment of the application.

Recommended Action: Issue tax certification.

**In addition to the above described facilities, the Agency determined that the following facilities ARE NOT pollution control facilities according to § 125.200 having the primary purpose of eliminating, preventing, or reducing air or water pollution or treating, pretreating, modifying or disposing of any potential solid, liquid or gaseous pollutant which if released without pretreatment, treatment, modification or disposal might be harmful, detrimental or offensive to human, plant or animal life, or to property and therefore ARE NOT recommended.**

Not applicable.

**Notes:**

Have determined plan drawings are adequate without additional section drawings showing pit depth of 8 ft. Additional Drawings are too burdensome for applicant and unnecessary for recommendation.

Perimeter tile as described by applicant is around the entire perimeter of the building. This does not need to be redrawn in the plans.

A flow diagram is not necessary as no other interconnected waste storage structures are included.

Nothing follows – SC - (September 11, 2025)

## Watershed Unit Tax Certification Review Sheet

Project Name: England Farms, Inc.  
Reviewer: WH

Date: September 13, 2019

Type: ☐ Agchem  
☒ Livestock

Log number: TC-141525

Applicant: Jean S. England Trustee  
576 Knox Rd. 1300E  
Maquon, IL 61458

Contact: Daniel S. England  
1368 Knox Rd. 140N  
Maquon, IL 61458  
Phone: 309-875-3482

Facility: England Farms, Inc.  
593 Knox Rd. 1300E  
Maquon, IL

Property Index#: 19-05-100-005

Parcel#:

Legal Description:  
NW of Section: 5 Twp: 9N R: 3E PM: 4<sup>th</sup>

County: Knox

Signature: Daniel S. England

Date Control Devices installed: October 2015

Title:

Wastes: ☒ Livestock waste is applied to cropland.  
☐ Agrichemical rinsate and spillage is recycled through the facility and/or land applied.  
☐ Other: \_\_\_\_\_

### Physical Description of Pollution Control Devices:

The livestock waste handling facilities consist of one (1) concrete manure pit (approximately 109 ft. x 41 ft. x 8 ft.) and the concrete slatted portion of the floor over the manure pit that capture and contain waste generated in the barn above. HDPE perimeter tiles (approximately 598 ft. x 8 in. x 2 in.) are located around the footing of the manure pits to prevent flotation of the pits. The facility collects, transports and stores livestock waste prior to cropland application.

Pollution control facilities requested by the applicant through Description of Pollution Control Facilities, Section C of the application form and the attached drawings.

One (1) concrete manure pits;  
Concrete slatted floor;  
Perimeter drainage tiles

A process flow diagram and a plan view of the pit is submitted with the application.

Recommended Action: Issue tax certification.



## ILLINOIS ENVIRONMENTAL PROTECTION AGENCY

1021 NORTH GRAND AVENUE EAST, P.O. BOX 19276, SPRINGFIELD, ILLINOIS 62794-9276 • (217) 782-3397

JB PRITZKER, GOVERNOR

JOHN J. KIM, DIRECTOR

217/782-0610

September 13, 2019

Mr. Daniel S. England  
1368 Knox Rd. 140N  
Maquon, IL 61458

Re: Illinois Property Tax: England Farms, Inc. – Maquon  
Livestock Waste Pollution Control Facilities  
Log No. TC-141525

Dear Mr. England:

The application for Illinois Property Tax Certification received July 23, 2019 for the above listed facilities has been reviewed and the following information is missing from the application:

1. Construction material (HDPE, plastics, etc.) and dimensions (diameter and length including the daylight drain to the outlet) of the perimeter drainage tile.
2. Revised Figure 1 or 2 that shows the location of perimeter drainage tile.
3. A diagram showing the flow of livestock waste from the initial animal waste collection or containment area through all pollution control facilities to final disposal on cropland.

Please provide the information listed above so the Agency can complete the review of the subject application. Please include the above log number on all correspondence.

If you have any questions or comments concerning the above items, please contact me at 217-782-0610.

Very truly yours,

A handwritten signature in black ink, appearing to read "Wei Han", written over a horizontal line.

Wei Han, P.E.  
Permit Section, Water Pollution Control  
Bureau of Water

WH:TC-141525.doc



## ILLINOIS ENVIRONMENTAL PROTECTION AGENCY

1021 NORTH GRAND AVENUE EAST, P.O. BOX 19276, SPRINGFIELD, ILLINOIS 62794-9276 • (217) 782-3397

JB PRITZKER, GOVERNOR

JOHN J. KIM, DIRECTOR

217/782-0610

September 15, 2020

Mr. Daniel S. England  
1368 Knox Rd. 140N  
Maquon, IL 61458

Re: Illinois Property Tax: England Farms, Inc. – Maquon  
Livestock Waste Pollution Control Facilities  
Log No. TC-141525

Dear Mr. England:

The application for Illinois Property Tax Certification received July 23, 2019 for the above listed facilities has been reviewed and letters were sent to you for additional information on September 13 and October 1, 2019, respectively.

1. Construction material (HDPE, plastics, etc.) and dimensions (diameter and length including the daylight drain to the outlet) of the perimeter drainage tile.
2. Revised Figure 1 or 2 that shows the location of perimeter drainage tile.
3. A diagram showing the flow of livestock waste from the initial animal waste collection or containment area through all pollution control facilities to final disposal on cropland.

Please provide the information listed above within 45 days. Please include the above log number on all correspondence. If the above information is not submitted within 45 days, the Illinois EPA will have no option other than to recommend that the Illinois Pollution Control Board deny the application.

If you have any questions or comments concerning the above items, please contact me at 217-782-0610.

Very truly yours,

A handwritten signature in black ink, appearing to read "Wei Han", followed by a stylized flourish.

Wei Han, P.E  
Permit Section, Water Pollution Control  
Bureau of Water

WH:TC-141525.doc

**Daniel S. England**

1368 Knox Road 140N  
Maquon, IL 61458  
(309)875-3482

**RECEIVED**  
SEP 25 2019

September 22, 2019

IEPA  
BOW/WPC/PERMIT SECTION

Wei Han, P.E  
Permit Section, Water Pollution Control  
Bureau of Water  
Illinois Environmental Protection Agency  
1021 North Grand Avenue East  
P.O. Box 19276  
Springfield, IL 62794-9276

Re: Illinois Property Tax: England Farms, Inc. — Maquon  
Livestock Waste Pollution Control Facilities  
Log No. TC-141525

Dear Mr. Han:

Your letter dated September 13, 2019 was reviewed and the following information was missing:

1. Physical location of the facilities in question. Township and section number of the site in question. Specific building(s) on the property site in question.
2. Attachments. Copies of the submitted drawings showing the facilities in question.
3. A diagram detailing the suggested method of showing flow of livestock waste from the initial animal waste collection or containment area through all pollution control facilities to final disposal on cropland, especially when cropland is not immediately adjacent to the facilities.

Please provide the information listed above so my business associates and I can prepare and return the appropriate materials required to meet the information request. Please include the property county, township and section number(s) on all correspondence.

If you have any questions or comments concerning the above items, please contact me at (309)875-3482.

Very truly yours,

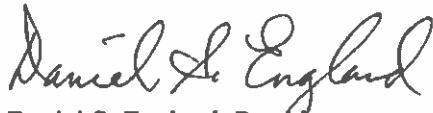

Daniel S. England, President  
England Farms, Inc.



## ILLINOIS ENVIRONMENTAL PROTECTION AGENCY

1021 NORTH GRAND AVENUE EAST, P.O. BOX 19276, SPRINGFIELD, ILLINOIS 62794-9276 • (217) 782-3397

JB PRITZKER, GOVERNOR

JOHN J. KIM, DIRECTOR

217/782-0610

October 1, 2019

Mr. Daniel S. England  
1368 Knox Rd. 140N  
Maquon, IL 61458

Re: Illinois Property Tax: England Farms, Inc. – Maquon  
Livestock Waste Pollution Control Facilities  
Log No. TC-141525

Dear Mr. England:

The application for Illinois Property Tax Certification received July 23, 2019 for the above listed facilities has been reviewed and the following information is missing from the application:

1. Construction material (HDPE, plastics, etc.) and dimensions (diameter and length including the daylight drain to the outlet) of the perimeter drainage tile.
2. Revised Figure 1 or 2 that shows the location of perimeter drainage tile.
3. A diagram showing the flow of livestock waste from the initial animal waste collection or containment area through all pollution control facilities to final disposal on cropland.

Please provide the information listed above so the Agency can complete the review of the subject application. Please include the above log number on all correspondence.

If you have any questions or comments concerning the above items, please contact me at 217-782-0610.

Very truly yours,

A handwritten signature in black ink, appearing to read "Wei Han".

Wei Han, P.E.  
Permit Section, Water Pollution Control  
Bureau of Water

WH:TC-141525.doc

Attachments

PC-191525

WT

**RECEIVED**

JUL 23 2019

APPLICATION FOR CERTIFICATION (PROPERTY TAX TREATMENT)  
 POLLUTION CONTROL FACILITY  
 AIR ☐ WATER ☒  
 ILLINOIS ENVIRONMENTAL PROTECTION AGENCY  
 P. O. Box 19276, Springfield, IL 62794-9276

IEPA

BOV/WPC/PERMIT SECTION

FOR AGENCY USE

This Agency is authorized to request this information under Illinois Revised Statutes, 1979, Chapter, 120, Section 502a-5. Disclosure of this information is voluntary. However, failure to comply could prevent your application from being processed or could result in denial of your application for certification.

File No.	Date Received	Certification No.	Date
Sec. A	Company Name <i>England Farms Inc</i>		
APPLICANT	Person Authorized to Receive Certification <i>JEAN S. ENGLAND TRUSTEE</i>		Person to Contact for Additional Details <i>Daniel S. England</i>
	Street Address <i>576 Knox Road 1300 E</i>		Street Address <i>1368 Knox Road 140N</i>
	Municipality, State & Zip Code <i>Maquon, IL 61458</i>		Municipality, State & Zip Code <i>Maquon, IL 61458</i>
	Telephone Number <i>(309) 875-3396</i>		Telephone Number <i>(309) 875-3482</i>
	Location of Facility Quarter Section      Township      Range <i>NW      9N      3E</i>		Municipality      Township <i>MAQUON</i>
	Street Address <i>593 Knox Road 1300 E</i>		County      Book Number <i>KNOX</i>
	Property Identification Number <i>19-05-100-005</i>		Parcel Number <i>19-05-100-005</i>
	Sec. B	Nature of Operations Conducted at the Above Location <i>Swine Breeding Building with Slotted Flooding over Manure Storage Pit</i>	
MANUFACTURING OPERATIONS	Water Pollution Control Construction Permit No. <i>LF095D250000</i>		Date Issued <i>10/16/15</i>
	NPDES PERMIT No.		Date Issued      Expiration Date
	Air Pollution Control Construction Permit No.		Date Issued
	Air Pollution Control Operating Permit No.		Date Issued
Sec. C	Describe Unit Process		
MANUFACTURING PROCESS	Materials Used in Process		
Sec. D	Describe Pollution Abatement Control Facility		
POLLUTION CONTROL FACILITY DESCRIPTION	Figure 1 shows the Swine Breeding Building layout. Flooring is slotted concrete above 8' deep concrete pit. Pit has perimeter tile drain which daylights 200' + from building as shown in Figure 2. Figure 3 shows satellite image. Nearest surface water is 1/2 mile from building site.		

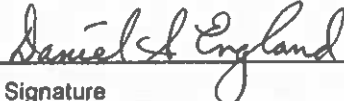
Sec. E	(1) Nature of Contaminants or Pollutants			
POLLUTION CONTROL FACILITY - CONTAMINANTS          ACCOUNTING DATA			Material Retained, Captured or Recovered	
	Contaminant or Pollutant	DESCRIPTION	DISPOSAL OR USE	
	Swine Manure	Liquid Manure	Direct Incorporated Land Application	
	(2) Point(s) of Waste Water Discharge <u>None</u>			
	Plans and Specifications Attached Yes <input checked="" type="checkbox"/> No <input type="checkbox"/>			
	(3)	Are contaminants (or residues) collected by the control facility?		Yes <input checked="" type="checkbox"/> No <input type="checkbox"/>
	(4)	Date installation completed <u>October 2015</u> status of installation on date of application <u>In Use</u>		
(5)	a. FAIR CASH VALUE IF CONSIDERED REAL PROPERTY:		\$ <u>150,000</u>	
	b. NET SALVAGE VALUE IF CONSIDERED REAL PROPERTY:		\$ <u>100,000</u>	
	c. PRODUCTIVE GROSS ANNUAL INCOME OF CONTROL FACILITY:		\$ <u>5362.80</u>	
	d. PRODUCTIVE NET ANNUAL INCOME OF CONTROL FACILITY:		\$ <u>2,681.40</u>	
	e. PERCENTAGE CONTROL FACILITY BEARS TO WHOLE FACILITY VALUE:		% <u>50 %</u>	
Sec. F	The following information is submitted in accordance with the Illinois Property Tax Code, as amended, and to the best of my knowledge, is true and correct. The facilities claimed herein are "pollution control facilities" as defined in Section 11-10 of the Illinois Property Tax Code.			
SIGNATURE				
	Signature	Title		
Sec. G	INSTRUCTIONS FOR COMPILING AND FILING APPLICATION			
General: Separate applications must be completed for each control facility claimed. Do not mix types (water and air). Where both air and water operations are related, file two applications. If attachments are needed, record them consecutively on an index sheet.				
Sec. A	Information refers to applicant as listed in the tax records and the person to be contacted for further details or for inspection of facilities. Define facility location by street address or legal description. A plat map location is required for facilities located outside of municipal boundaries. The property identification number is required.			
Sec. B	Self-explanatory. Submit copies of all permits issued by local pollution control agencies. (e.g. MSD Construction Permit)			
Sec. C	Refers to manufacturing processes or materials on which pollution control facility is used.			
Sec. D	Narrative description of the pollution control facility, indicating that its primary purpose is to eliminate, prevent or reduce pollution. State the type of control facility. State permit number, date, and agency issuing permit. A narrative description and a process flow diagram describing the <u>pollution control facility</u> . Include a listing of each major piece of equipment included in the claimed fair cash value for real property. Include an <u>average</u> analysis of the influent and effluent of the control facility stating the collection efficiency.			
Sec. E	List air contaminants, or water pollution substances released as effluents to the manufacturing processes. List also the final disposal of any contaminants removed from the manufacturing processes. Item (1) - Refers to pollutants and contaminants removed from the process by the pollution control facility. Item (2) - Refers to water pollution but can apply to water-carried wastes from air pollution control facilities. Submit drawings, which clearly show (a) Point(s) of discharge to receiving stream, and (b) Sewers and process piping to and from the control facility. Item (3) - If the collected contaminants are disposed of other than as wastes, state the disposition of the materials, and the value in dollars reclaimed by sale or reuse of the collected substances. State the cost of reclamation and related expense. Item (4) - State the date which the pollution control facility was first placed in service and operated. If not, explain. Item (5) - This information is essential to the certification and assessment actions. This accounting data must be completed to activate project review prior to certification by this Agency.			
Sec. F	Self-explanatory. Signature must be a corporate authorized signature.			
	Submit to:  Illinois EPA P.O. Box 19276 Springfield, IL 62794-9276	Attention:  Al Keller Permit Section Division of Water Pollution Control	Attention:  Donald E. Sutton Permit Section Division of Air Pollution Control	



ISGS - PLSS Search

Search for an address or locate on map

593 Knox Rd 1300 E Maquon IL 61458 USA

Show results within 0 Miles



< IL PLSS Search

Approximate Distance: 0 mi

IL PLSS

County	Twp.	Rng.	Sec.
Knox	9N	3E	5
Quadrangle	Maquon		

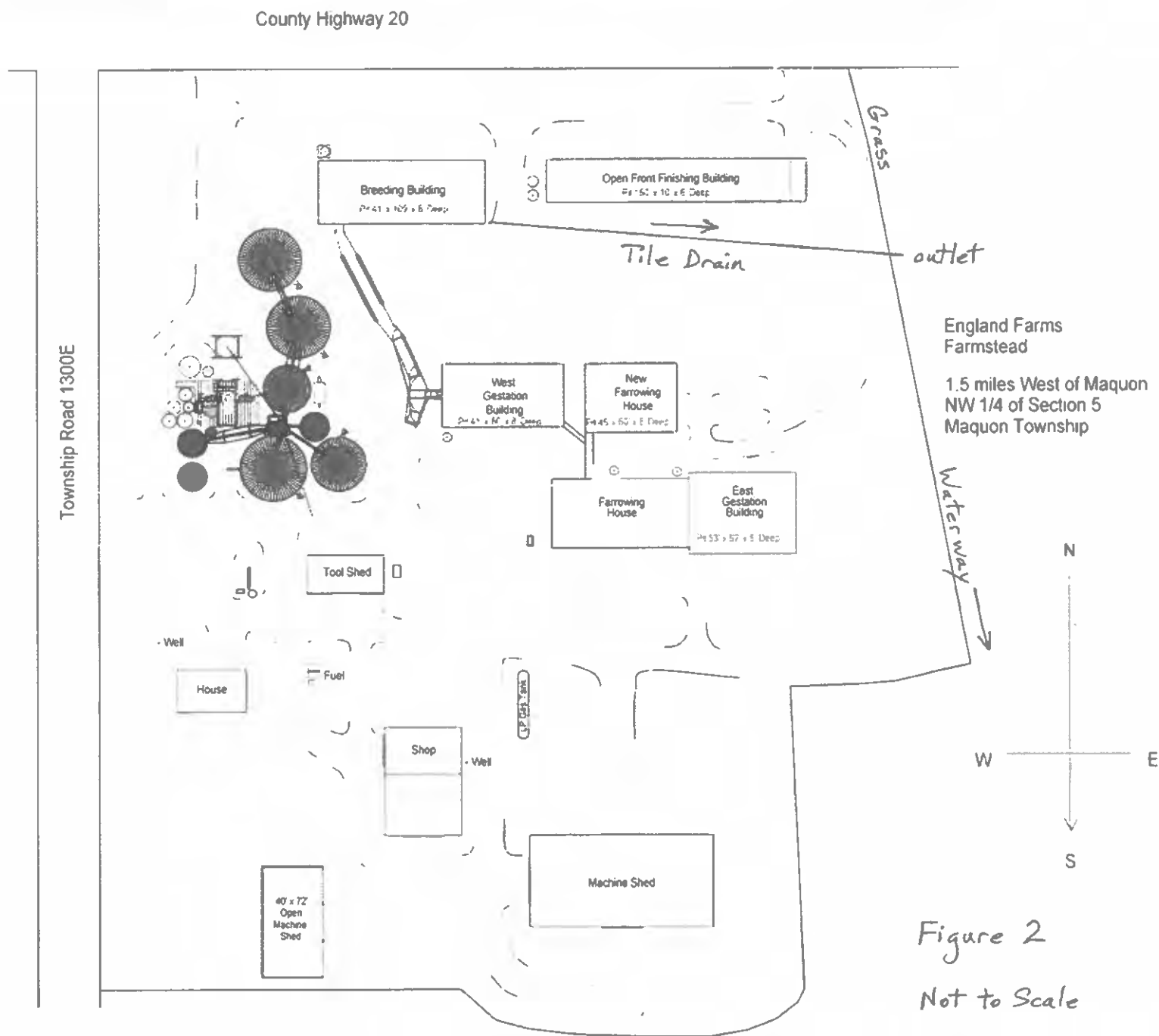

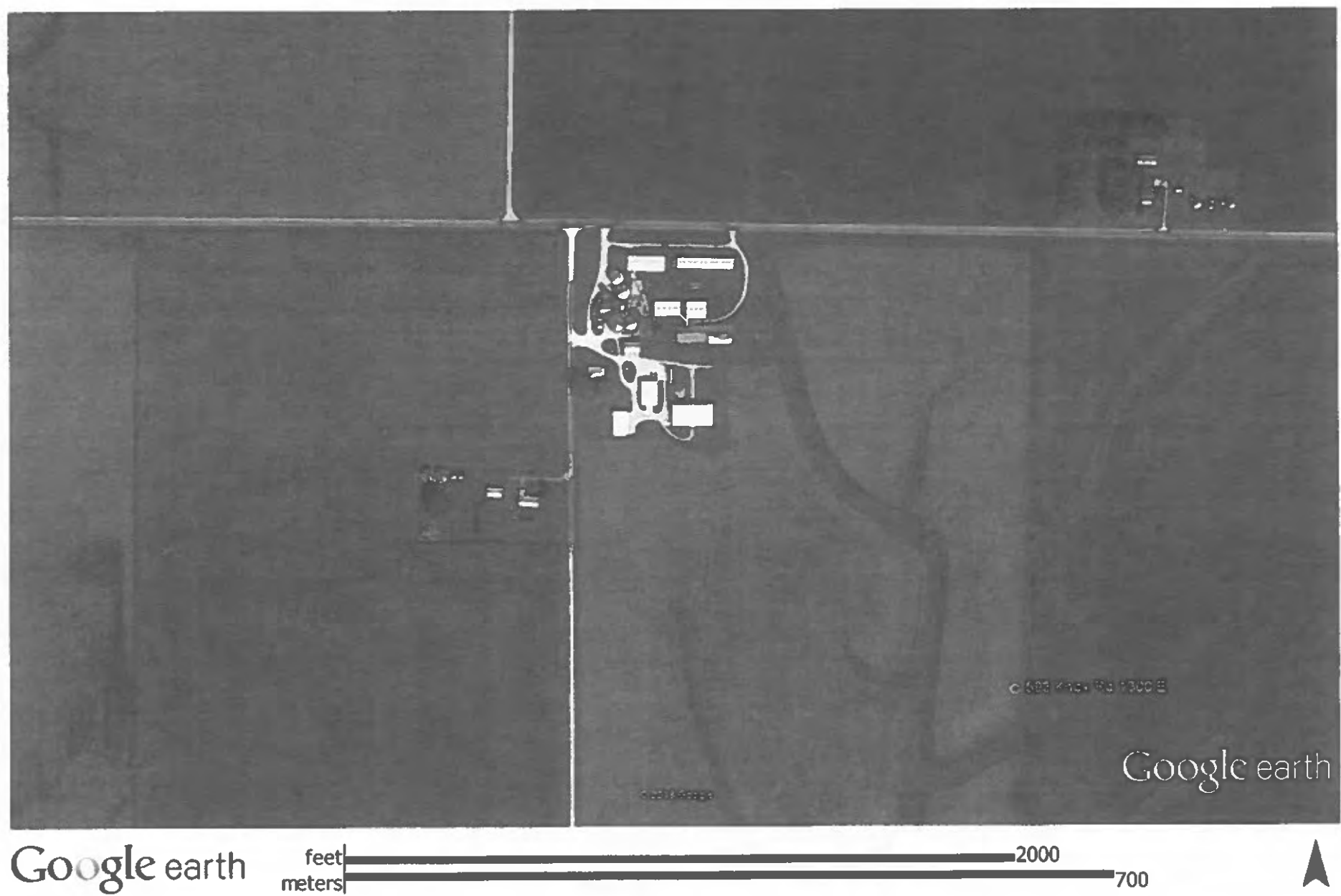
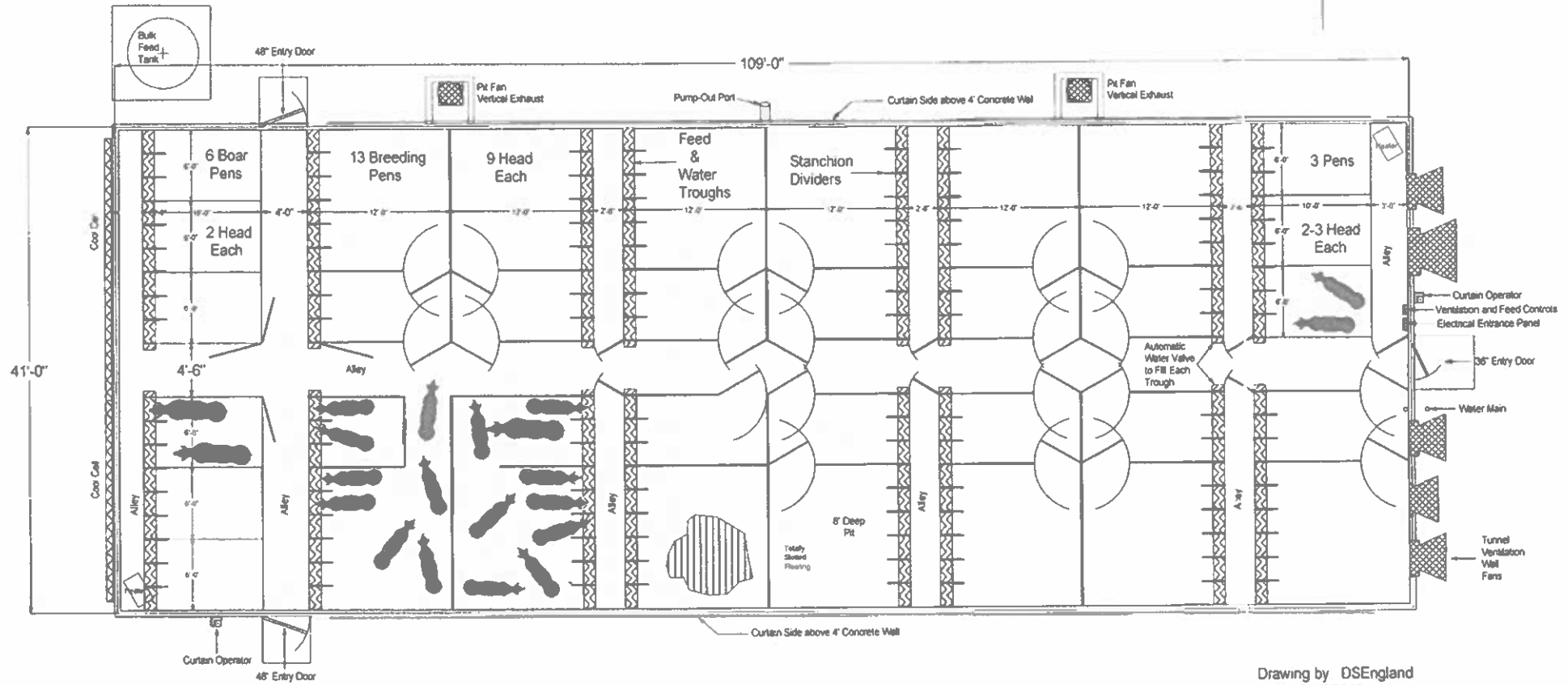

Figure 3

# Swine Breeding Building



Drawing by DSEngland  
Date: 3/17/2015  
Scale: 1" = 10'-0"

Figure 1

**Gove, Darren**

---

**From:** Daniel S. England <dsengland@mymctc.net>  
**Sent:** Tuesday, September 9, 2025 8:05 AM  
**To:** Gove, Darren  
**Subject:** [External] Re: Illinois EPA Tax Certification request (TC-141525)

Yes, it is 4" field tile.

Sent from my U.S.Cellular® Smartphone  
Get Outlook for Android

---

**From:** Gove, Darren <Darren.Gove@Illinois.gov>  
**Sent:** Tuesday, September 9, 2025 7:25:58 AM  
**To:** dsengland@mymctc.net <dsengland@mymctc.net>  
**Cc:** Mike McGraw <mcgrama53@gmail.com>; Linda England <linda.england@comcast.net>  
**Subject:** RE: Illinois EPA Tax Certification request (TC-141525)

Sir,  
Thank you for the information, we will make attempt to proceed with approval of the deep pit as described. Could you confirm for me if the 200-foot length of drainage pipe to daylight is 4" corrugated drainpipe or other?

Darren

**From:** dsengland@mymctc.net <dsengland@mymctc.net>  
**Sent:** Monday, September 8, 2025 5:48 PM  
**To:** Gove, Darren <Darren.Gove@Illinois.gov>  
**Cc:** Mike McGraw <mcgrama53@gmail.com>; Linda England <linda.england@comcast.net>  
**Subject:** [External] Re: Illinois EPA Tax Certification request

Hi Darren,

The attached drawing was drafted by me and shows that the perimeter tile drain of the "Breeding Building" daylights to outlet as required by the Illinois Department of Agriculture's Livestock Facilities Management Program.

The building has since been remodeled as a "Finishing Building."

The answers to your questions are as follows:

1. No.
2. The plans drawn up by Frank & West Environmental Engineers, Inc., Drawing Number 15-122CP, and dated 3/24/15 for England Farms, Inc. of Maquon, Illinois are a matter of public record submitted to and approved by the Illinois Department of Agriculture and in compliance with all Livestock Facilities Management Program provisions and requirements in effect at that time,

before construction of the facility. In those plans, 4"x8" plastic Form-A-Drain (also called Perma-Drain) was used as both the form for the concrete floor and the perimeter drain tile.

3. I regret that due to technology issues I am unable at this time to scan and copy scanned documents into my computer. The original plans detail the 8' deep, 41' wide, 109' long underfloor livestock waste storage structure (35,752 cu. ft.) as shown in the Frank & West drawings that were approved by the Illinois Department of Agriculture (IDOA) and placed on file with the IDOA. Please consult with them if further proof, specifications and drawings are required.

Thank you for looking into this long-delayed, long-overdue matter.



Daniel S. England  
England Farms, Inc.  
1368 Knox Road 140N  
Maquon, IL 61458  
Home/Office: (309)875-3482  
Cell: (309)368-5033

---

**From:** Gove, Darren <[Darren.Gove@Illinois.gov](mailto:Darren.Gove@Illinois.gov)>  
**Sent:** Monday, September 8, 2025 11:34 AM  
**To:** [dsengland@mymctc.net](mailto:dsengland@mymctc.net) <[dsengland@mymctc.net](mailto:dsengland@mymctc.net)>  
**Subject:** Illinois EPA Tax Certification request

Mr England,

Good afternoon, thank you for taking my call just a little while ago. As discussed, please provide answers to the following questions so that we may proceed with making our recommendation.

1. Are any other structures shown on figure 2 (see attached) besides the concrete deep pit measuring 109 ft. (length) x 41 ft. (width) x 8 ft. (depth) within the Swine Breeding Building, with slotted concrete flooring, and perimeter pipe daylighting 200 ft. from the building being requested?
2. please specify the material and dimensions of the perimeter tile being requested.
3. Please provide a sketch of the concrete deep pit showing the vertical (depth) dimension including dimensions.

Your response via email is welcome. Please let me know if you have any questions.  
Thank you.



**Darren Gove**  
Environmental Protection Specialist IV  
CWA 401/Mines, Permit Section, Bureau of Water  
217-524-3033  
[darren.gove@Illinois.gov](mailto:darren.gove@Illinois.gov)

Join our team: [Illinois EPA Employment](#)

**Gove, Darren**

---

**From:** Gove, Darren  
**Sent:** Monday, September 8, 2025 1:35 PM  
**To:** dsengland@mymctc.net  
**Subject:** Illinois EPA Tax Certification request  
**Attachments:** Figure 2.pdf

Mr England,

Good afternoon, thank you for taking my call just a little while ago. As discussed, please provide answers to the following questions so that we may proceed with making our recommendation.

1. Are any other structures shown on figure 2 (see attached) besides the concrete deep pit measuring 109 ft. (length) x 41 ft. (width) x 8 ft. (depth) within the Swine Breeding Building, with slotted concrete flooring, and perimeter pipe daylighting 200 ft. from the building being requested?
2. please specify the material and dimensions of the perimeter tile being requested.
3. Please provide a sketch of the concrete deep pit showing the vertical (depth) dimension including dimensions.

Your response via email is welcome. Please let me know if you have any questions.  
Thank you.



**Darren Gove**  
Environmental Protection Specialist IV  
CWA 401/Mines, Permit Section, Bureau of Water  
217-524-3033  
darren.gove@Illinois.gov

Join our team: [Illinois EPA Employment](#)

STATE OF ILLINOIS

)

COUNTY OF SANGAMON

)

)

)

**CERTIFICATE OF SERVICE**

I, the undersigned attorney at law, hereby certify that I have served on the date of November 7, 2025, the attached **NOTICE, APPEARANCE and RECOMMENDATION OF THE ILLINOIS ENVIRONMENTAL PROTECTION AGENCY**, upon the following persons by causing to be mailed a true copy thereof in an envelope duly addressed, bearing proper first class postage, and deposited in the United States mail at Springfield, Illinois:

England Farms, Inc.  
Jean S. England - Trustee  
576 Knox Road 1300 E  
Maquon, Illinois 61458

**Copies also provided electronically as follows:**

Illinois Department of Revenue  
via email at REV.PropTaxApp@illinois.gov  
101 West Jefferson  
P.O. Box 19033  
Springfield, Illinois 62794

**[Electronic Filing]**

Clerk  
Illinois Pollution Control Board  
60 E. Van Buren St., Ste. 630  
Chicago, Illinois 60605

ILLINOIS ENVIRONMENTAL PROTECTION AGENCY

/s/ Joshua Leopold  
Assistant Counsel  
Division of Legal Counsel  
2520 W Iles Ave.  
P.O. Box 19276  
Springfield, Illinois 62794-9276  
217.782.5544  
217.782.9143 (TDD)