

**BEFORE THE ILLINOIS POLLUTION CONTROL BOARD**

LC Family Farms – Taylor Ridge )  
(Property Identification Number ) PCB No. 23-  
22-23-300-003 ) (Tax Certification)  
)

**NOTICE**

**PLEASE TAKE NOTICE** that I have today filed with the Office of the Clerk of the Pollution Control Board an APPEARANCE and RECOMMENDATION OF THE ILLINOIS ENVIRONMENTAL PROTECTION AGENCY, copies of which are herewith served upon you.

LC Family Farms  
15601 98<sup>th</sup> St W  
Taylor Ridge, Illinois 61284

Don Brown, Clerk  
Illinois Pollution Control Board  
James R. Thompson Center  
100 West Randolph Street, Suite 11-500  
Chicago, Illinois 60601

**Copies also provided electronically as follows:**

Illinois Department of Revenue  
via email at REV.PropTaxApp@illinois.gov  
101 West Jefferson  
P.O. Box 19033  
Springfield, Illinois 62794

ILLINOIS ENVIRONMENTAL PROTECTION AGENCY

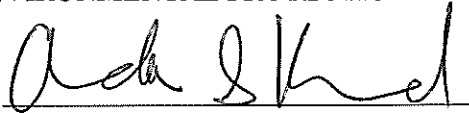
By:   
Amanda S. Kimmel  
Assistant Counsel  
Division of Legal Counsel

DATED: August 4, 2022

Illinois Environmental Protection Agency  
1021 North Grand Avenue East  
Post Office Box 19276  
Springfield, Illinois 62794-9276  
(217) 782-5544

**BEFORE THE ILLINOIS POLLUTION CONTROL BOARD**

**LC Family Farms – Taylor Ridge  
(Property Identification Number  
22-23-300-003)**

)  
) **PCB No. 23-**  
) **(Tax Certification)**  
)

**A P P E A R A N C E**

The undersigned, as one of its attorneys, hereby enters an **APPEARANCE** on behalf of Respondent, Illinois Environmental Protection Agency.

ILLINOIS ENVIRONMENTAL PROTECTION AGENCY

By:   
Amanda S. Kimmel  
Assistant Counsel  
Division of Legal Counsel

DATED: August 4, 2022

Illinois Environmental Protection Agency  
1021 North Grand Avenue East  
Post Office Box 19276  
Springfield, Illinois 62794-9276  
(217)782-5544

**BEFORE THE ILLINOIS POLLUTION CONTROL BOARD**

LC Family Farms – Taylor Ridge )  
(Property Identification Number ) PCB No. 23-  
22-23-300-003 ) (Tax Certification)  
)

**RECOMMENDATION OF THE ILLINOIS  
ENVIRONMENTAL PROTECTION AGENCY**

The Illinois Environmental Protection Agency (“Illinois EPA”) hereby files its Recommendation pursuant to Section 125.204 of the regulations of the Illinois Pollution Control Board (“Board”), 35 Ill. Adm. Code 125.204.

1. On April 11, 2022, the Illinois EPA received a request from LC Family Farms – Taylor Ridge (log number TC-146255, Exhibit A) for an Illinois EPA recommendation regarding the tax certification of water pollution control facilities pursuant to 35 Ill. Adm. Code 125.204.
2. The facility’s address is: LC Family Farms  
15601 98<sup>th</sup> St W  
Taylor Ridge, Illinois 61284

The proposed water pollution control facilities in this request are located in the SW 1/4 of Section 23, Township 16-North, Range 3-West of the 4th PM in Rock Island County, at the above street address and consist of the following:

Livestock waste management facilities consisting of one (1) concrete livestock waste pit measuring 391 ft. (length) x 51 ft. (width) x 8 ft. (depth) with 10 concrete pump out pits approximately 6 ft. (length) x 5 ft. (width) x 8 ft. (depth) and approximately 884 linear feet of 4 inch diameter perimeter drain tile and approximately 19,941 sq. ft. of concrete slatted flooring over this manure pit.

These livestock waste management facilities are used to collect, transport, and/or store livestock waste prior to cropland application, and are further described in Exhibit A.

3. Section 11-10 of the Property Tax Code, 35 ILCS 200/11-10 (2020), and Section 125.200(a) of the Board's regulations, 35 Ill. Adm. Code 125.200(a), define "pollution control facilities" as:

any system, method, construction, device or appliance appurtenant thereto or any portion of any building or equipment, that is designed, constructed, installed or operated for the primary purpose of: eliminating, preventing, or reducing air or water pollution ...or treating, pretreating, modifying or disposing of any potential solid, liquid or gaseous pollutant which if released without treatment, pretreatment modification or disposal might be harmful, detrimental or offensive to human, plant or animal life, or to property.

4. In order to receive preferential tax treatment as pursuant to 35 ILCS 200/11-5 (2020), pollution control facilities must be certified as such by the Board, 35 ILCS 200/11-20 (2020) and 35 Ill. Adm. Code 125.200(a).
5. Upon receipt of a tax certification application, the Illinois EPA must file a recommendation on the application with the Board, 35 Ill Adm. Code 125.204(a).
6. Based on the information in the application and the purpose of the facility, it is the Illinois EPA's engineering judgment that the described facilities may be considered "pollution control facilities," pursuant to 35 Ill. Adm. Code 125.200(a), with the primary purpose of eliminating, preventing, or reducing water pollution, or as otherwise provided in 35 Ill. Adm. Code 125.200, and are eligible for tax certification from the Board.

WHEREFORE, the Illinois EPA recommends that the Board issue the requested tax certification.

ILLINOIS ENVIRONMENTAL PROTECTION AGENCY

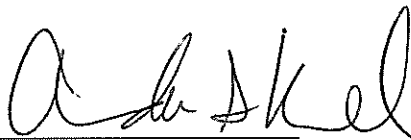
By:   
Amanda S. Kimmel  
Assistant Counsel  
Division of Legal Counsel

Dated: August 4, 2022

Illinois Environmental Protection Agency  
1021 North Grand Ave. E.  
P.O. Box 19276  
Springfield, Illinois 62794-9276  
217/782-5544



**ILLINOIS ENVIRONMENTAL PROTECTION AGENCY**

1021 NORTH GRAND AVENUE EAST, P.O. BOX 19276, SPRINGFIELD, ILLINOIS 62794-9276 • (217) 782-3397

JB PRITZKER, GOVERNOR

JOHN J. KIM, DIRECTOR

**Memorandum**

To: Mike Roubitchek, Division of Legal Counsel

From: Darin E. LeCrone, P.E., Manager, Permit Section, Division of Water Pollution Control, Illinois Environmental Protection Agency *DL*

Date:

Re: LC Family Farms - Taylor Ridge  
Recommendation of Tax Certification  
Log No.: TC-146255  
BOW ID No.: W1618090010  
Property Index Number: 22-23-300-003

The Bureau of Water received a request on April 11, 2022 from LC Family Farms, having a principal place of business at 15301 98th St W, Taylor Ridge, IL 61284, for an Illinois EPA recommendation regarding the tax certification of water pollution control facilities pursuant to 35 Il. Adm. Code 125.204. We offer the following recommendation.

The water pollution control facilities in this request include the following:

LC Family Farms  
15601 98th St W  
Taylor Ridge, IL 61284

SW 1/4 of Section 23, Township 16-North, Range 3-West of the 4th PM in Rock Island County.

Livestock waste management facilities consisting of:

One (1) concrete livestock waste pit measuring 391 ft. (length) x 51 ft. (width) x 8 ft. (depth) with 10 concrete pump out pits measuring 6 ft. (length) x 5 ft. (width) x 8 ft. (depth) and approximately 884 linear feet of 4 inch diameter perimeter drain tile and approximately 19,941 sq. ft. of concrete slatted flooring over this manure pit.

These livestock waste management facilities are used to collect, transport and/or store livestock wastes prior to cropland application.

These facilities are further described in the enclosed applications and supporting documents.

Based on the information included in this submittal, it is our engineering judgment that the above proposed facilities may be considered "Pollution Control Facilities" under 35 IAC 125.200(a), with the primary purpose of eliminating, preventing, or reducing water pollution, or as otherwise provided in this section, and therefore eligible for tax certification from the Illinois Pollution Control Board. The Bureau of Water therefore recommends that the Board issue the requested tax certification for these facilities.

If you have any questions regarding the above, please contact Darren Gove at 217/782-0610.

2125 S. First Street, Champaign, IL 61820 (217) 278-5800  
2009 Mall Street Collinsville, IL 62234 (618) 346-5120  
9511 Harrison Street, Des Plaines, IL 60016 (847) 294-4000  
595 S. State Street, Elgin, IL 60123 (847) 608-3131

2309 W. Main Street, Suite 116, Marion, IL 62959 (618) 993-7200  
412 SW Washington Street, Suite D, Peoria, IL 61602 (309) 671-3022  
4302 N. Main Street, Rockford, IL 61103 (815) 987-7760

Illinois EPA - Bureau of Water - Division of Pollution Control  
Title 35 Subtitle A Part 125 Tax Certifications  
Illinois EPA Review Notes for:  
**Agency Recommendation of Pollution Control Facilities.**

---

**BOW ID #:** W1618090010

**Project Name:** LC Family Farms

**Date application received:** 4/11/2022

**Reviewer:** DRG

**Log number:** TC-146255

**Legal Description:**  
SW 1/4 of Section 23 Twp: 16-North Range: 3-  
West PM: 4th

**County:** Rock Island

**Facility Contact:**

**Phone:** ..

**Pollution Control Facility Type:**  
Swine Livestock Waste Management Facility

**Property ID:** 22-23-300-003

**Applicant:** LC Family farms  
15301 98th St W  
Taylor Ridge, IL 61284

**Facility:** LC Family Farms  
15601 98th St W  
Taylor Ridge, IL 61284

**Date Control Devices installed:** 12/1/2018

**Application Signature by:** Lauren Crawford

**Title:** Owner

Contents of Application: 3-pages Old application form, flow diagram sheet, 1 page description with plan drawing, and a plat book map of facility location.

Is there a pollutant control flow diagram? **Yes**

Is there sufficient diagrams showing the pollution control facilities? **Yes**

**This facility generates the following pollutants and prevents their discharge as indicated:**

Livestock waste is collected and land applied to cropland.

**Physical description of pollution control facilities that ARE recommended:**

Livestock waste management facilities consisting of:

One (1) concrete livestock waste pit measuring 391 ft. (length) x 51 ft. (width) x 8 ft. (depth) with 10 concrete pump out pits measuring 6 ft. (length) x 5 ft. (width) x 8 ft. (depth) and approximately 884 linear feet of 4 inch diameter perimeter drain tile and approximately 19,941 sq. ft. of concrete slatted flooring over this manure pit.

These livestock waste management facilities are used to collect, transport and/or store livestock wastes prior to cropland application.

**Notes:** Nothing follows – DRG - (June 14, 2022)



# Illinois Environmental Protection Agency

1021 North Grand Avenue East • P.O. Box 19276 • Springfield • Illinois • 62794-9276 • (217) 782-3397

## Application for Certification (Property Tax Treatment) Pollution Control Facility

W1618090010

FOR AGENCY USE ONLY	
File Number: <u>TC-146255</u>	Date Rec'd: <u>4-11-22</u>
Certification Number: _____	Date: _____

Facility Type (check one):  Air  Water

This form is to be used for any application for certification of property tax treatment for a pollution control facility for air or water from the Illinois EPA. Separate applications must be completed for each control facility claimed. Do not mix types of facilities. If both air and water operations are related, file two applications.

**RECEIVED**  
APR 11 2022

If attachments are needed, record them consecutively on an index sheet.

You may complete this form online, save a copy locally, print, sign and submit it to

EPA  
BOW/WPC/PERMIT SECTION

Illinois EPA  
Attention: Ray E. Pilapil, Permit Section  
Division of Air Pollution Control  
1021 North Grand Avenue East, P.O. Box 19276  
Springfield, IL 62794-9276

Illinois EPA  
Attention: Al Keller, Permit Section  
Division of Water Pollution Control  
1021 North Grand Avenue East, P.O. Box 19276  
Springfield, IL 62794-9276

### I. Applicant Information:

Company Name: <u>LC Family Farms</u>	Person to Contact for Additional Details: <u>Lauren Crawford</u>
Person Authorized to Receive Certification: <u>Lauren Crawford</u>	Street Address: <u>15301 98th St W</u>
Street Address: <u>15301 98th St W</u>	City: <u>Taylor Ridge</u> State: <u>FL</u>
City: <u>Taylor Ridge</u> State: <u>FL</u>	Zip: <u>61284</u> Phone: <u>309 372 4647</u>
Zip: <u>61284</u> Phone: <u>309 781 8099</u>	Email Address: <u>llc Crawford33@gmail.com</u>
Email Address: <u>llc Crawford33@gmail.com</u>	

### II. Facility Information:

Facility Location: Quarter Section: 23 Township: 16N Range: 3W  
Municipality: \_\_\_\_\_ Township: Edington  
Note: A plat map location is requested for facilities located outside of municipal boundaries.  
Address: 15601 98th St W City: Taylor Ridge FL 61284  
State: FL Zip Code: 61284 County: Rock Island Book Number: \_\_\_\_\_  
Property Index Number: 22-23-300-003

Note: The Property Index Number is the numerical reference used to identify a parcel of real property for assessment and taxation purposes

### Manufacturing Operations Information:

Nature of Operations Conducted at the Above Location:

Swine Production

### Permit Information:

WPC Construction Permit Number: _____	Date Issued: _____
NPDES Permit Number: _____	Date Issued: _____ Exp. Date: _____
APC Construction Permit Number: _____	Date Issued: _____
APC Operating Permit Number: _____	Date Issued: _____ Exp. Date: _____

Note: Submit copies of all relevant permits issued by local pollution control agencies. (e.g. MSD Construction Permit)

This Agency is authorized to request this information under 415 ILCS 5/4(b)(2012). Disclosure of this information is voluntary and no penalties will result from the failure to provide the information. However, the absence of the information could prevent your application from being processed or could result in denial of your application.



**Manufacturing Process Information:**

Please provide information on the manufacturing process and materials on which pollution control facility is used, including each major piece of equipment associated with the pollution control facility (or low sulfur dioxide emission coal fueled device).  
Description of the Process:

**Materials Used in the Process.**

**Pollution Control Facility Information:**

Please provide a narrative description of the pollution control facility (or low sulfur dioxide emission coal fueled device), and an explanation of why its primary purpose is to eliminate, prevent or reduce pollution. State the type of control facility, as well as a narrative description and a process flow diagram describing the pollution control facility. Include an average analysis of the influent and effluent of the control facility stating the collection efficiency, if applicable.

Describe the Pollution Control Facility (or Low Sulfur Dioxide Emission Coal Fueled Device):

One concrete manure pit (51' x 39' x 8' deep pit) Building consists of 10 concrete pumpout pits 5' x 6' x 8' deep. A concrete floor over the pit, the manure pit is surrounded by 884' of 2x4 plastic drain tile around the foundation. The foundation tubing has one inspection port, 8ft deep 8" diameter.

Describe the Primary Purpose of the Pollution Control Facility (or Low Sulfur Dioxide Emission Coal Fueled Device): <sup>See attached</sup>

contain manure and protect the water supply <sub>Drawings</sub>

Identify the statute or regulation (federal or state), or local ordinance, if any, requiring the installation of the subject pollution control facility (or low sulfur dioxide emission coal fueled device)

**Nature of Contaminants or Pollutants:**

List air contaminants or water pollution substances released as effluents to the manufacturing processes. Also list the final disposal of any contaminants removed from the manufacturing processes.

Contaminant or Pollutant	Material Retained, Captured or Recovered	
	Description	Disposal or Use
Swine Manure	Swine Manure	Fertilizer for Crops

Note: Contaminant or pollutant means that which is removed from the process by the pollution control facility.

**Point(s) of Waste Water Discharge:**

Identify the location of the discharge to the receiving stream. This will typically refer to a source of water pollution but can include water-carried wastes from air pollution control facilities.

Plans and Specifications Attached  Yes  No

Submit Drawings, which clearly show:

- (a) Point(s) of discharge to receiving stream; and
- (b) Sewers and process piping to and from the control facility.

Are contaminants (or residues) collected by the control facility?  Yes  No

Note: If the collected contaminants are disposed of other than as wastes, state the disposition of the materials, and the value dollars reclaimed by the sale or reuse of the collected substances. State the cost of reclamation and related expense.

**Project Status:**

Date Installation Completed: 12-2018

Provide the date the pollution control facility was first placed into service and operated. If not, explain.

Status of installation on date of application:

The facility is still in use and there have been no improvements to the certified portion

**III. Verification and Signature:**

The following information is submitted in accordance with the Illinois Property Tax Code, as amended, and to the best of my knowledge is true and correct.

*Any person who knowingly makes a false, fictitious, or fraudulent material statement, orally or in writing, to the Illinois EPA commits a Class 4 felony. A second or subsequent offense after conviction is a Class 3 felony. (415 ILCS 5/44(h))*

Lauren Crawford  
Printed Name:

Owner  
Title:

For incorporated entities, signature should be from an authorized corporate representative

[Signature]  
Signature:

3-28-2022  
Date:

L.F 7610160000

One wean to finish hog building measuring (51"x391"x8" deep pit) Building consist of a concrete foundation and concrete slatted floors over 100% of the 51"x391"x8" deep pit. A finished grade around the building prevents fresh water from entering the pit .Manure storge is adequate enough to contain 14 months of manure production which will safely protect the well and nearby crop from contamination. An inspection port 8" deep and 8" in diameter is used to monitor the perimeter tile around the building and soil near the pit area. Manure from the pits will be pumped annually and applied by sub surface injection at an appropriate rate to cropland nearby.

Building (51'x391"x8" deep pit) diagram

Grass venation surrounds the building and field road

10 concrete pump outs measuring 5"x6"x8" deep protrude on both sides of the building foundation. Concrete pump outs indicate where the manure will be removed annually and then will be applied at an appropriate agronomic cropland nearby. See figure #1

Slatted concrete flooring over liquid manure pit. See fig. #2

Inspection port for perimeter tile surrounding both buildings, See fig #3

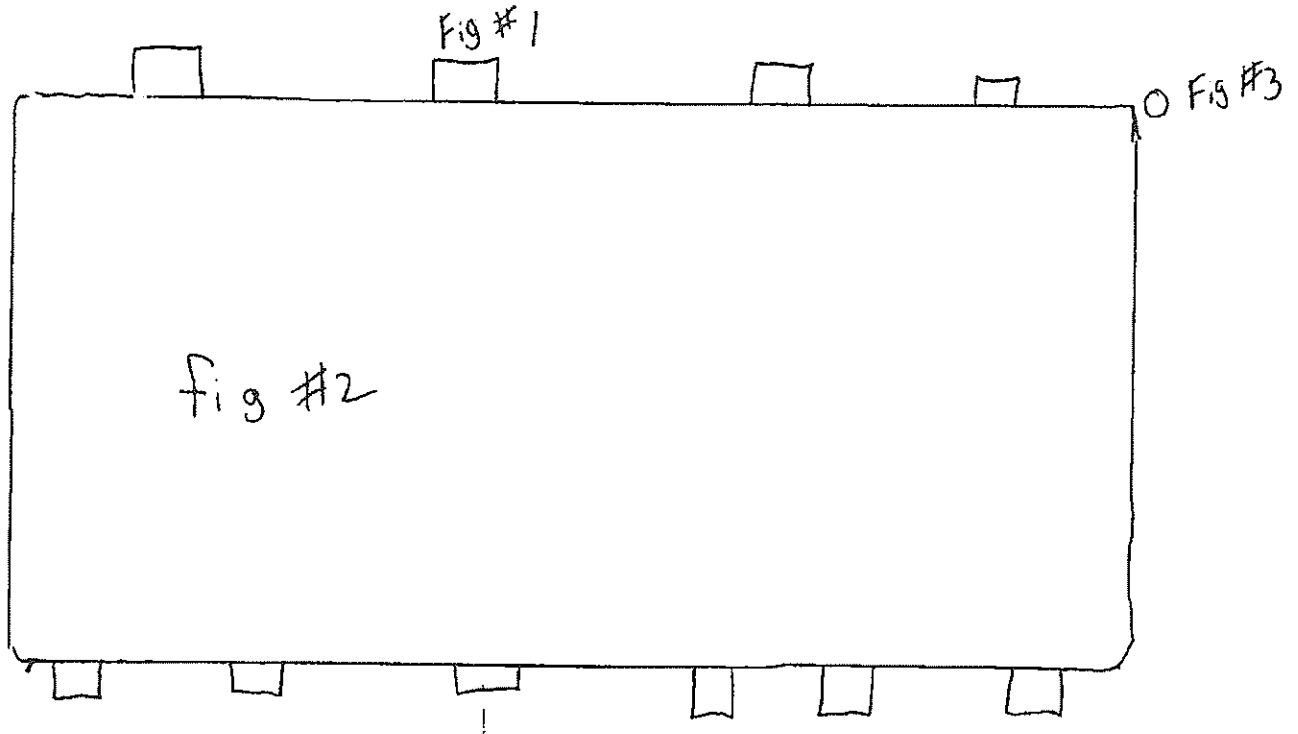

- Federal or State Highway
- ▬ County or Township Roads
- ▬ Railroads
- Graveling or Farm Vail

SCALE IN MILES

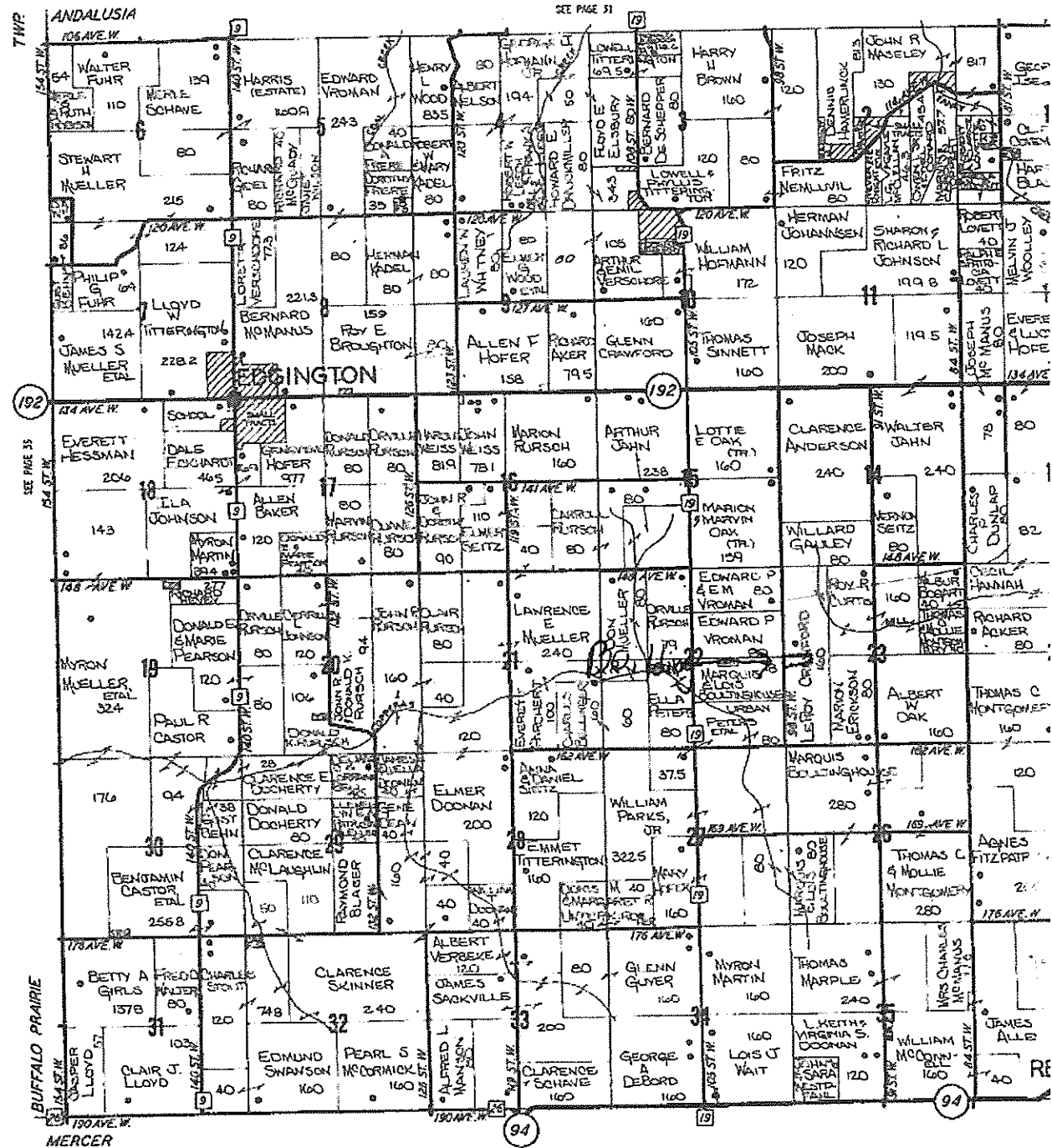

# REYNOLDS STATE BANK

R. C. WAIT, Vice President  
 H. B. WAIT, President  
 NORMAN E. WAIT, Cashier

ESTABLISHED 1888  
 TELEPHONE 309-372-4242

REYNOLDS, ILLINOIS



Manure Generation Flow Diagram

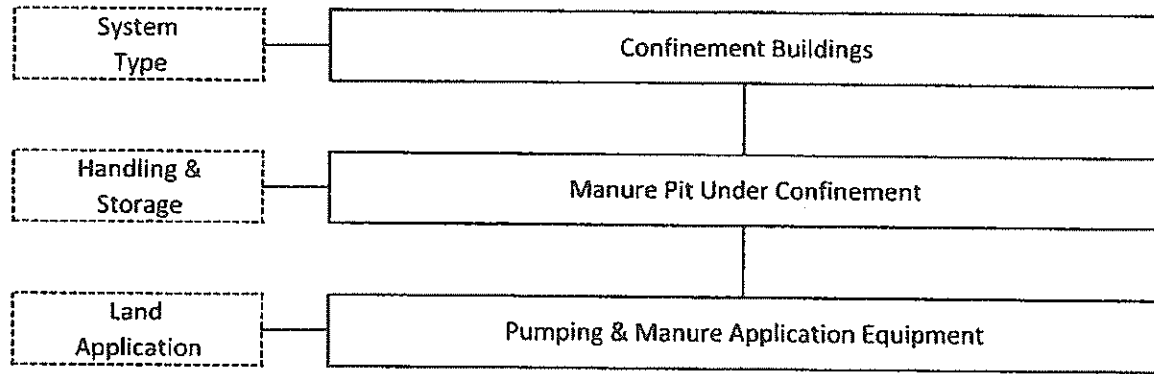

STATE OF ILLINOIS

COUNTY OF SANGAMON

)  
)  
)  
)  
)

**CERTIFICATE OF SERVICE**

I, the undersigned attorney at law, hereby certify that I have served on the date of May 20, 2022 the attached **NOTICE**, **APPEARANCE** and **RECOMMENDATION OF THE ILLINOIS ENVIRONMENTAL PROTECTION AGENCY**, upon the following persons by causing to be mailed a true copy thereof in an envelope duly addressed, bearing proper first class postage, and deposited in the United States mail at Springfield, Illinois:

LC Family Farms  
15601 98<sup>th</sup> St W  
Taylor Ridge, Illinois 61284

**Copies also provided electronically as follows:**

Illinois Department of Revenue  
via email at REV.PropTaxApp@illinois.gov  
101 West Jefferson  
P.O. Box 19033  
Springfield, Illinois 62794

**[Electronic Filing]**

Clerk  
Illinois Pollution Control Board  
James R. Thompson Center  
100 West Randolph Street, Suite. 11-500  
Chicago, Illinois 60601

ILLINOIS ENVIRONMENTAL PROTECTION AGENCY

/s/ Amanda S. Kimmel  
Assistant Counsel  
Division of Legal Counsel  
1021 North Grand Avenue East  
P.O. Box 19276  
Springfield, Illinois 62794-9276  
217.782.5544  
217.782.9143 (TDD)